

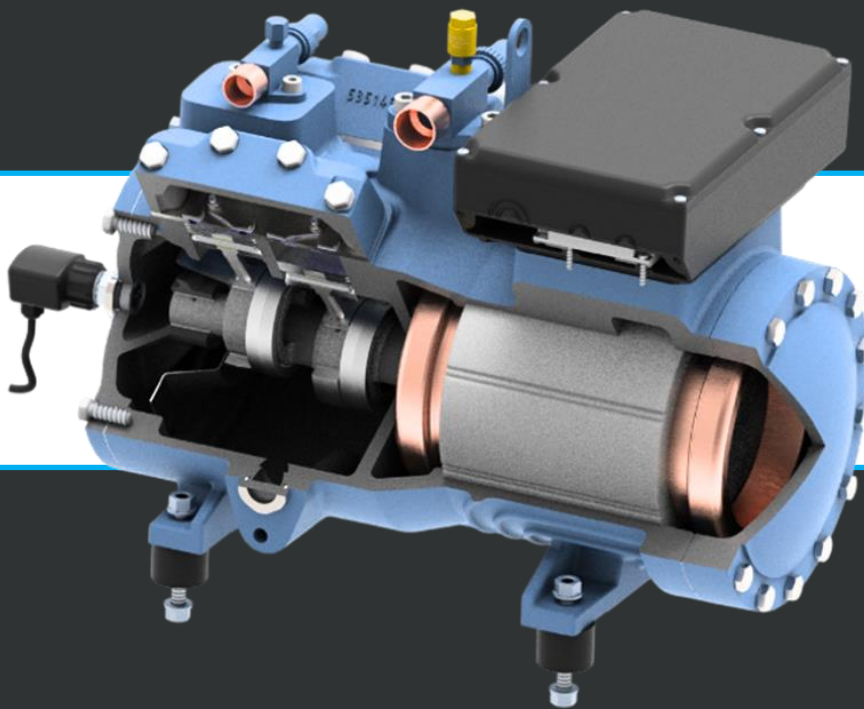







User and Maintenance Manual SPS Series

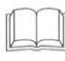

Summary

1	 SAFETY INSTRUCTIONS	5
1.1	 Importance of the manual.....	5
1.2	Responsibility limitations	5
1.3	 Symbols on the manual.....	6
1.4	 Safety signals.....	7
1.5	Machine switched-off status.....	7
1.6	Responsibilities of the operator	8
1.7	Misuse	8
1.8	Copyright	9
1.9	 Conformity Declaration	9
2	GENERAL	10
2.1	Identification.....	10
2.2	Nameplate	11
2.3	Directives and Standards Reference	12
2.4	Residual risks	12
2.5	Identification of dangerous areas.....	13
2.6	Introduction	14
2.6.1	Compressors with splasher lubrication (SPS21/22).....	15
2.6.2	Compressors with splasher lubrication (SPS41)	16
2.6.3	Compressors with splasher lubrication (SPS42)	17
3	LUBRICATION	18
3.1	Lubrication systems.....	18
3.2	Splasher lubrication.....	18
3.3	Crankcase heater.....	19
3.3.1	Oil heater assembly procedure.....	20
3.4	Oil sight glass	20
3.5	Electronic oil level switch	20
3.6	Anti-foaming valves	21
3.7	Lubricant of the compressor.....	21
4	COMPONENTS	22
4.1	Suction filter.....	22
4.2	Shut-off valves - Pipes connection.....	22

4.3	Shaft and connecting rods	23
4.3.1	Compressor models SPS21/22 and SPS41/42.....	23
4.4	Pistons.....	24
4.5	Valve plates	24
4.6	Sleeve bearings.....	26
4.7	Trust bearing washer	26
5	ELECTRICAL MOTOR.....	27
5.1	Motor.....	27
5.2	Motor protection module (INT69B2).....	27
5.3	Motor thermistor	28
5.4	Electrical box.....	28
5.5	Terminal board.....	29
6	DATA	30
6.1	Technical data	30
7	DIMENSIONAL DRAWINGS AND PACKAGING.....	31
7.1	Dimensional drawings.....	31
7.2	Packaging.....	33
8	TRANSPORT, HANDLING AND STORAGE	35
8.1	Receiving and unpacking.....	35
8.2	Transport & Handling	35
8.2.1	Carriage of packaged compressor.....	35
8.3	Storage.....	36
8.4	Handling and lifting	36
9	APPLICATION RANGE.....	37
9.1	General.....	37
10	OPERATIVE INSTRUCTION	38
10.1	Compressor requirements.....	38
10.2	Installation and commissioning.....	40
10.3	Vibration damper.....	40
10.4	Electrical connection.....	41
10.5	Pressure Switch.....	41
10.6	Pressure limit	41
10.7	Temperature limit	42
10.8	Running time	42
10.9	Leakage detection/ vacuuming	42
10.10	Lubricant charge.....	43

10.11 Refrigerant charge.....	43
10.12 Start-up procedure.....	44
10.13 Trouble-shooting.....	45
11 MAINTENANCE.....	47
11.1 Information for maintenance	47
11.2 Lubricant-refrigerant system	48
11.3 Sludges	48
11.3.1 Main causes.....	48
11.3.2 Low to avoid sludge.....	48
11.4 Corrosion.....	49
11.4.1 Main causes.....	49
11.4.2 How to avoid corrosion.....	49
11.5 Coppering.....	49
11.5.1 Main causes.....	49
11.5.2 How to avoid coppering.....	49
11.6 Icing	50
11.6.1 Main causes.....	50
11.6.2 How to avoid icing	50
11.7 Relief for maintenance.....	50
11.8 Rules for a good oil management.....	51
12 EXTENT OF DELIVERY	52
12.1 Standard delivery	52
12.2 Optional accessories.....	52



1 SAFETY INSTRUCTIONS

1.1 Importance of the manual

This manual contains the description of the operation and the necessary instructions to properly execute the main operations of use, ordinary and periodic maintenance of the machine.



A prerequisite to ensure safe working conditions is compliance with all safety warnings and all instructions contained herein. It must also ensure compliance with the local safety regulations currently in force in the installation location of the machine as well as the general safety regulations. The information contained herein is intended for professional users who must have specific knowledge of how to use the machine, must be authorized, trained and properly instructed.



We recommend the use of original parts and accessories. The non-original parts will invalidate the warranty and may also be dangerous, reducing the life and performance of the machine.



This manual, in case of transfer or sale, must always be delivered with the machine. If it becomes lost or damaged, you have to ask for a copy to the manufacturer of the machine or to the previous owner.

The manual is considered an integral part of the machine.

1.2 Responsibility limitations

All indications and warnings given in this manual have been prepared taking into account the rules and regulations in force, the current state of the art of the technology and the skills and knowledge acquired.

The manufacturer assumes no responsibility for any damage caused by:

- failure to follow instructions contained in this user manual;
- usage outside of the intended purposes;
- use of non-specialized personnel;
- unauthorized modifications;
- technical changes;
- use of non-original spare parts and wearing parts.

If special versions have been requested, additional options have been ordered or technical updates have been applied, it is possible that the components actually supplied are changed with respect to the descriptions and illustrations in this manual. The obligations agreed in the supply contract, the general terms and conditions and the conditions of supply of the manufacturer and the legal provisions in force at the time of signing the contract are intended as valid.



1.3 Symbols on the manual

The following **symbols** are used in this manual to get your attention how they should behave in all operating situations:



RECOMMENDATIONS: contains advice and recommendations as well as useful information for safe and trouble-free operations.



CAUTION!: indicates a potentially hazardous situation which, if neglected, can lead to material damages. Carefully follow the instructions and work carefully to avoid accidents, injuries and material damages.



The warnings are accompanied by signal words that identify the severity of the danger.

ADVICE!: indicates a potentially hazardous situation which, if neglected, may cause minor or moderate injury.

WARNING!: indicates a potentially hazardous situation which, if left untreated, can cause death or serious injury.

RISK!: indicates a situation of imminent danger that, if left untreated, can cause serious injury or death. Carefully follow the instructions and work carefully to avoid accidents, injuries and material damages.



MECHANICAL OPERATOR: the indicated steps must be carried out by specialized mechanical operator that operates respecting the rules of national security and any specific rules of the workplace.



ELECTRICAL OPERATOR: the indicated steps must be performed by a specialized electrical operator that operates in compliance with the safety regulations concerning energized equipment.



MAINTENANCE OPERATOR: the indicated steps must be carried out exclusively by the operator in charge of the maintenance of the machinery. As such he has to:

- integrally read and understood the contents of this manual;
- operate respecting the rules of national security and any specific rules of the workplace.



HANDLING OPERATOR: the indicated steps must be carried out exclusively by the operator enabled to handle loads that operates respecting the rules of national security and any specific rules of the workplace.



COMPANY SAFETY MANAGER: the company responsible for safety must be informed of any residual risks present in the machine and has to take care of any application to local safety regulations or specific of workplace and environment.

1.4 Safety signals

On the machine are affixed pictograms that identify any dangerous areas



It is mandatory of the operator to keep in perfect status and replace them when they are no longer legible.



DANGER - VOLTAGE: indicates hazardous situations due to electrical voltage. In case of failure to follow safety instructions, there is a risk of serious injury or death.



DANGER - HIGH TEMPERATURE: indicates hazardous situations due to machine parts at high temperature. In case of failure to follow safety instructions, there is a risk of minor injuries and burns.



DANGER - RISK OF EXPLOSION: indicates hazardous situations due to objects in pressure and the possible intervention of the safety valves. In case of failure to follow safety instructions, there is a risk of serious injury or death.



DANGER - CRUSHING: indicates hazardous situations due to parts of the machine under rotation. In case of failure to follow safety instructions, there is a risk of serious injury.



DANGER - MOVING PARTS: indicates hazardous situations due to parts of the machine under rotation. In case of failure to follow safety instructions, there is a risk of serious injury.



DANGER - AUTOMATIC RESTART: indicates hazardous situations to automatically restart the machine. In case of failure to follow safety instructions, there is a risk of serious injury. In case the automatic restart is enabled, it is mandatory to affix appropriate warnings.

Tab. 1 Pictograms

1.5 Machine switched-off status

Defines the condition of safety of the machine, to be applied before any maintenance and/or adjustment operations.

It provides for the compulsory execution of the following steps:



- 1) Turning off the machine using the stop button.
- 2) Rotation of the main switch of the compressor to position 0 and padlocked.
- 3) Main switch turned to position OFF or 0.
- 4) Close the outlet valve of the air compressor or tank (mounted versions).
- 5) Release of the residual pressure in the compressor and the tank (mounted versions).



1.6 Responsibilities of the operator

The machine is intended for industrial purposes and uses.

The operator of the machine is therefore subject to the legal obligations concerning safety in the workplace. In particular, the operator must:



- identify, through a risk assessment, the possible dangers arising from particular working conditions existing at the place of use of the machine;
- ensure that all employees who use the machine have read and understood the user manual. Also instruct regularly the personnel on how to use the machine and inform them of the possible dangers;
- implement, through operating instructions, the behavioral requirements necessary for the operation of the machine at the place of use;
- establish clear responsibilities for installation, operation, maintenance and cleaning of the machine;
- check regularly, for all duration of use of the machine, if the operating instructions correspond to the current version of the regulations;
- adjust, if necessary, the operating instructions to the new rules, regulations and conditions of use.

1.7 Misuse

Below are listed the actions required in order to prevent improper use of the machine:

- Use the machine only if it is in perfect technical condition. Promptly repair faults that can compromise security.
- It is not permitted to make changes to the machine that may compromise its security of the same.
- Disconnect the power supply before performing regular maintenance, cleaning and repair work and ensure that it is impossible for the machine to restart (disconnect the controls).
- Do not by-pass the safety devices or put them out of order.
- All operations on the machine and/or on electrical equipment must be carried out by specialized personnel.
- Repairs and maintenance operations must be carried out only when the machine is off. Make sure that it is impossible for an accidental restarting of the machine!
- When performing operations on the machine, the machine must not be under pressure. Close the air outlet valve and vent piping between the machine and the air receiver. Manually release the overpressure of the compressor from the safety valve. Observe the indication of the pressure gauge!
- The protective devices of the starter must be removed only when the machine is turned off and must be reassembled correctly at the end of the operations. Remove the touch guard only when the machine and the pressure line have cooled down.
- The provisions relating to environmental protection require that all fluids handled during the maintenance operations (eg. Oil) are collected and disposed in accordance with current regulations.



1.8 Copyright

The content, texts, drawings, pictures and any other representation are protected by copyright and trade mark rights. Any violation is punishable. It is forbidden the reproduction, even partial and by any means, and the use and/or disclosure of the content without prior written declaration by the manufacturer.

1.9 Conformity Declaration

The following is an example of the conformity declaration and the information contained in. The original document is delivered in hard copy with the product.



<p>Dichiarazione di incorporazione</p> <p>Ai sensi dell'allegato II, parte 1, sezione B della Direttiva Macchine 2006/42/CE.</p> <p>Il fabbricante: SRM Italy Srl E. Majorana 10/12 - 36045 Lonigo - Vicenza - ITALY</p> <p>Con la presente dichiara che le seguenti Quasi-Macchine:</p> <p>Moto-compressori semiermetici a pistone per condizionamento e refrigerazione :</p>	<p>Declaration of Incorporation</p> <p>As per EC Machines Directive 2006/42/EC, attachment II, part 1, section B.</p> <p>The manufacturer: SRM Italy Srl E. Majorana 10/12 - 36045 Lonigo - Vicenza - ITALY</p> <p>Hereby declare that the following partly-completed machines:</p> <p>Semi-hermetic piston compressors for refrigeration and air-conditioning applications</p>	<p>Déclaration de l'incorporation</p> <p>En vertu de l'annexe II, part 1, section B de la Directive Machine 2006/42/CE.</p> <p>Le fabricant: SRM Italy Srl E. Majorana 10/12 - 36045 Lonigo - Vicenza - ITALY</p> <p>Par la présente déclare que les suivantes Quasi-machines suivantes:</p> <p>Moto-compresseurs semi-hermétiques à piston pour la réfrigération et le conditionnement d'air:</p>
---	--	---

SP2L 003	SP2H 006	SRC-M-300	SP4L060	SB4L1200
SP2L 004	SP2H 008	SRC-M-340	SP4LF080	SB4L1400
SP2L 005	SP2H 009	SRC-M-390	SP4LF100	SB6L1600
SP2L 006	SP2H 075		SP4LF120	SB6L2000
SP2L 075	SP2H 100	SRC-F-185	SP4HF100	SB6L2500
SP2L 100	SP2H 150	SRC-F-222	SP4HF120	SB6L3000
SP2L 130	SP2H 180	SRC-F-258	SP4HF150	
SP2L 150	SP2H 200	SRC-F-295	SP4HF200	
SP2L 200	SP2H 300			
SP2L 300	SP2H 400	ORC-F-188	SP4LN060	
SP2L 320	SP2H 420	ORC-F-226	SP4LN080	
SP2L 400	SP2H 500	ORC-F-264	SP4LN100	
SP4L 500	SP2H 520	ORC-F-300	SP4LN120	
SP4L 550	SP2H 700		SP4HN100	
SP4L 600	SP2H 750	SRC-L-160	SP4HN120	
	SP2H 800	SRC-L-180	SP4HN150	
			SP4HN200	
			SP4L150	
			SP4L180	
			SP4L220	
			SP4L250	
			SP6L270	
			SP6L300	
			SP6L400	
			SP8L500	
			SP8L600	
			SP4H220	
			SP4H250	
			SP4H300	
			SP4H350	
			SP6H370	
			SP6H400	
			SP6H500	
			SP8H600	
			SP8H700	

2 GENERAL

2.1 Identification

The **RefComp SPS** series piston compressors are reciprocating oil lubricated compressors specifically designed to operate with carbon dioxide, R744 (CO₂) gas as refrigerants and to be installed in refrigeration system.

Any whatsoever claim for damages resulting from misuse is excluded. The designer and the operator of the machine where compressor is installed are solely responsible for any damage resulting from misuse.



THE COMPRESSOR USAGE FOR SCOPES DIFFERENT AND NOT INCLUDED IN THE INDICATED EXCLUDES THE MANUFACTURER FROM ANY RESPONSIBILITY FOR THE RISKS THAT SHOULD BE CAUSED AND FOR ANY DAMAGES TO THE MACHINE, PEOPLE OR THINGS.

The identification of the compressor model is possible by the following scheme:

	SPS	2	2	-9
SPS	= Semi-hermetic Piston Subcritical compressor			
2	= n° of cylinders			
2	= Housing size			
-9	= Displacement			

The compressor in question has been designed and manufactured taking into account the feedback that emerged from a careful analysis of risks and tending to achieve, given the state of the art, the objectives set by the essential requirements of safety and health provided by European Directives. In the Tab. 2 are listed the referenced European Directives and Standards (EN):



2.2 Nameplate

All the data necessary to identify the compressor, in addition to the main electrical and mechanical data, are printed on a metal plate attached in the casing of the compressor. Here below is shown the label applied to compressors with electric motors Y/ Δ .

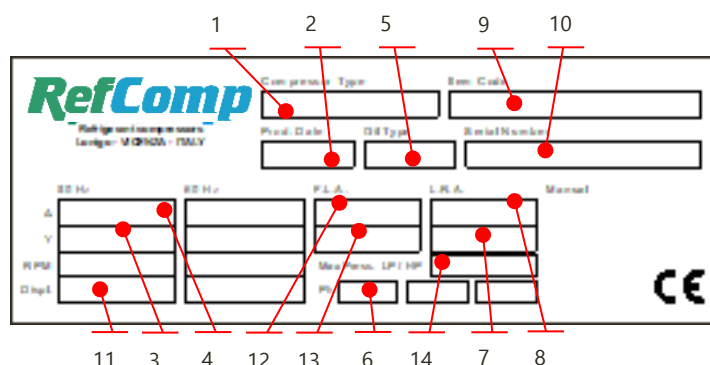

Fig. 1 - Name plate for compressors with Y/ Δ

Field	Information reported	Description
1.	Compressor type	Compressor identification name
2.	Production date	Production date of the compressor
3.	Starting voltage	Supply voltage of the starting configuration: <ul style="list-style-type: none"> • First winding in PW • Y connection in Y/Δ
4.	Running voltage	Supply voltage of the starting configuration: <ul style="list-style-type: none"> • Full winding in PW • Δ connection in Y/Δ
5.	Oil charge	POE - PAG
6.	Frequency	Nominal frequency of electric motor Hz
7.	Starting current	Starting current with starting connection: <ul style="list-style-type: none"> • Y connection in Y/D
8.	DOL current	Direct On Line starting current: <ul style="list-style-type: none"> • D connection
9.	Item code	Code of the compressor that identify the compressor configuration
10.	Serial number of compressor	Code to be used for any communication to RefComp concerning the specific compressor
11.	Displacement	Refrigerant moved by compressor at full load (Nominal frequency of electric motor 50Hz or 60Hz)
12.	Full load ampere (F.L.A.)	Maximum current drawn by the compressor
13.	Full load ampere (F.L.A.) 2	Maximum current drawn by the compressor if connected in starting mode
14.	Maximum working pressure	Maximum working pressure on Low pressure side (LP) / High pressure side (HP)

Table 1

2.3 Directives and Standards Reference

The compressor in question has been designed and manufactured taking into account the feedback that emerged from a careful analysis of risks and tending to achieve, given the state of the art, the objectives set by the essential requirements of safety and health provided by European Directives.

In the Tab. 2 are listed the referenced European Directives and Standards (EN):

Directive	Description
2006/42/EC	"Machinery Directive on the approximation of the laws of the Member States relating to machinery".
2014/35/EC	"Low Voltage Directive on the approximation of the laws of the Member States relating to electrical equipment designed for use within certain voltage limits".
2014/30/EU	"Electromagnetic Compatibility Directive on the approximation of the laws of the Member States relating to electromagnetic compatibility".
EN 12693:2008	"Refrigerating systems and heat pumps - Safety and environmental requirements - Positive displacement refrigerant compressors"
EN 60204-1	"Safety regulations concerning basic electrical equipment of machines".

Tab. 2 - Reference standards and directives

2.4 Residual risks

We inform the authorized operators that, despite the manufacturer has adopted all the measures possible to make the construction of the compressor sure, remain potential residual risks described here below:

Residual risk n° 1	DANGER OF BEING AFFECTED BY GAS PRESSURE
Frequency of exposure	Low and accidental. There may be exposure if the operator decides to perform voluntarily impropriety, prohibited and not reasonably foreseeable.
Extent of the damage	Serious lesions (non reversible).
Solutions adopted	Respect of the correct procedure for maintenance operation. Safety signal.

Tab. 3 - Residual risk

2.5 Identification of dangerous areas

Dangerous areas of the compressor are identified in the following images.



These areas have to be considered into the risk assessment of the machine where the compressor is installed and appropriate precautions must be taken to reduce residual risks (see chapter 2.2)

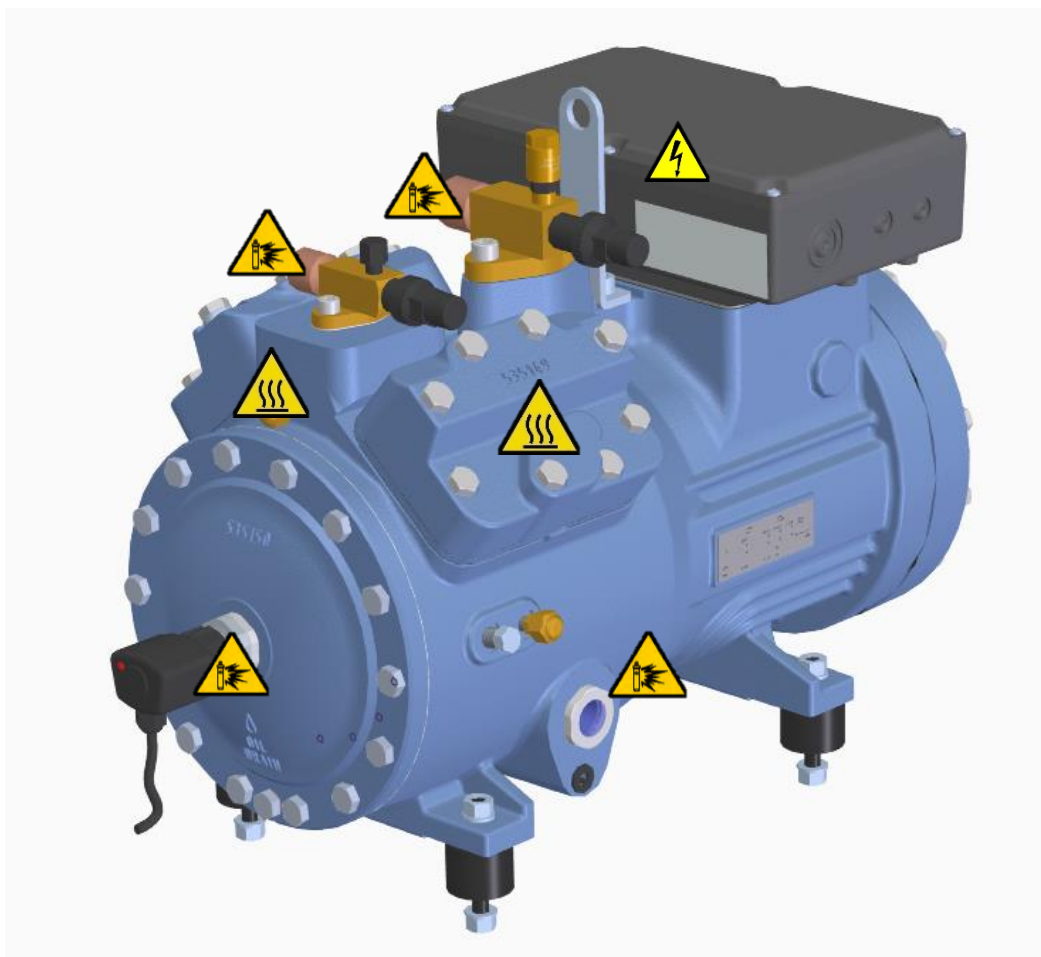

Fig. 2 - Dangerous area identification

2.6 Introduction

SPS series has 19 models of semi-hermetic reciprocating compressors with 2 or 4 cylinders, designed to operate with R744 gas as refrigerants and to be installed in refrigeration system. Compressors sizes are totally 19, with displacement from 1,5 to 48,5 m³/h at 50 Hz.

Mod. SPS		SPS21-1.5	SPS21-2	SPS21-2.5	SPS21-3	SPS21-3.5	SPS21-4.5	SPS21-5.5	SPS21-6.5	SPS22-8	SPS22-9	SPS22-11
No. of cylinder		2										
Nominal motor power	HP	0.5	0.7	0.7	1	2	3	3	4	4	5	6
Displacement at 50Hz 60 Hz	m ³ /h	1.5	1.8	2.3	2.8	3.6	4.5	5.5	6.7	7.8	9.2	11.2
		1.8	2.1	2.8	3.4	4.3	5.4	6.6	7.9	9.4	11	13.4
Lubrication		Splasher										
Mod. SPS		SPS41-13	SPS41-15	SPS41-18	SPS41-22	SPS42-29	SPS42-35	SPS42-41	SPS42-48			
No. of cylinder		4										
Nominal motor power	HP	7	9	10	12	15	20	25	30			
Displacement at 50Hz 60 Hz	m ³ /h	13	15.6	18.4	22.3	28.7	34.7	41.3	48.5			
		15.6	18.7	22	26.8	34.4	41.6	6.6	7.9			
Lubrication		Splasher										

Tab. 4

2.6.1 Compressors with splasher lubrication (SPS21/22)

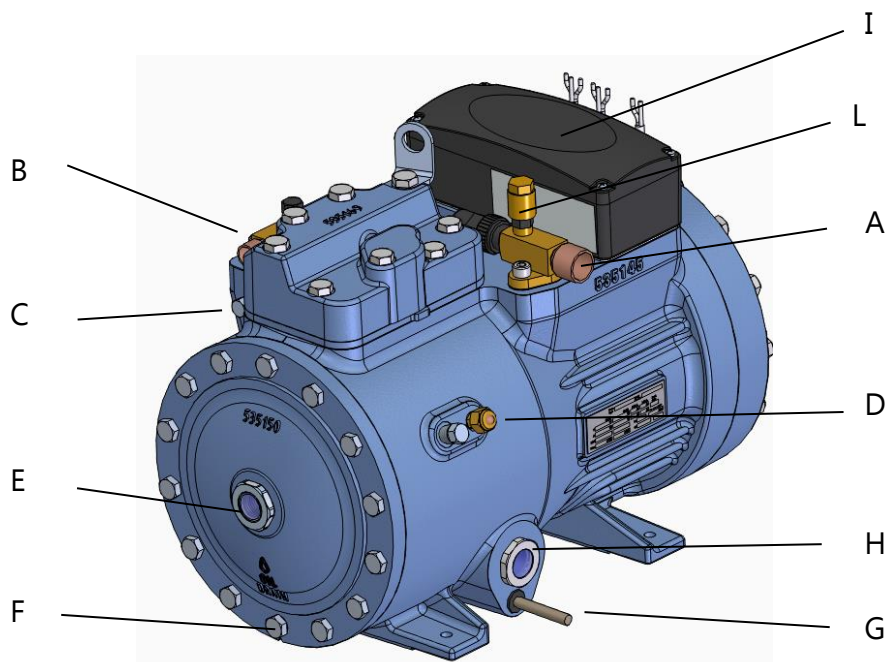

Fig. 3 - Model SPS21/22 (splasher lubrication)

- | | | |
|-------------------------------------|----------------------------|--------------------------|
| A) Suction shut-off valve | D) Low pressure connection | G) Crankcase heater |
| B) Discharge shut-off valve | E) Optical oil sensor cap | H) Oil level sight glass |
| C) Discharge temperature connection | F) Oil discharge | I) Electrical box |
| | | L) Safety Valve |

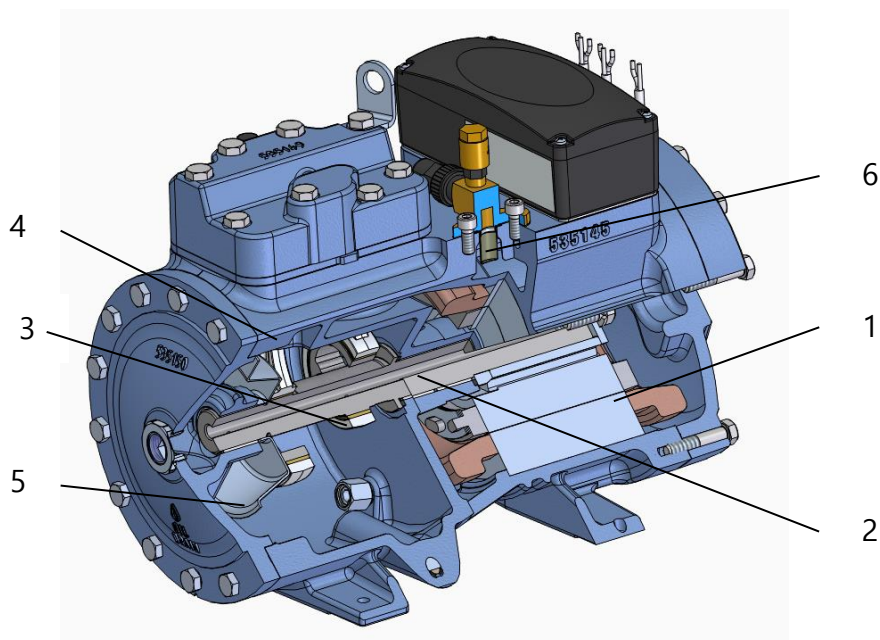

Fig. 4 - Cross section of SPS21/22 (splasher lubrication)

- | | |
|---------------------|-------------------------|
| 1) Electrical motor | 4) Piston |
| 2) Shaft | 5) Oil centrifugal disk |
| 3) Connecting rod | 6) Suction filter |

2.6.2 Compressors with splasher lubrication (SPS41)

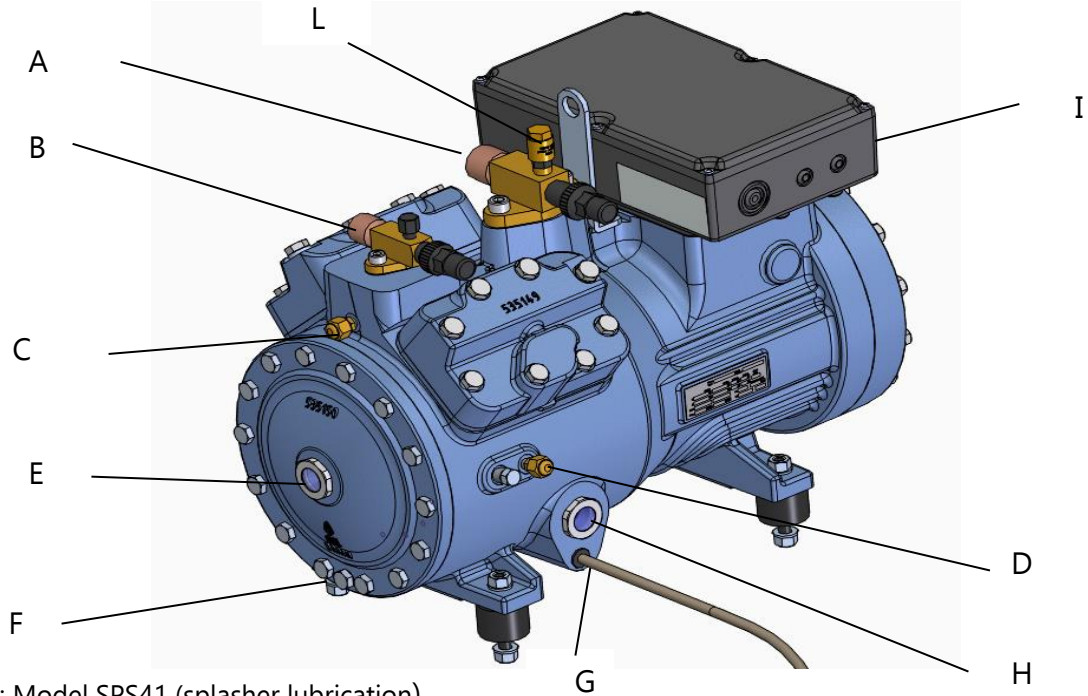

Fig. 5: Model SPS41 (splasher lubrication)

- | | | |
|-------------------------------------|---------------------------|--------------------------|
| A) Suction shut-off valve | E) Optical oil sensor cap | H) Oil level sight glass |
| B) Discharge shut-off valve | F) Oil discharge | I) Electrical box |
| C) Discharge temperature connection | G) Crankcase heater | L) Safety Valve |
| D) Low pressure connection | | |

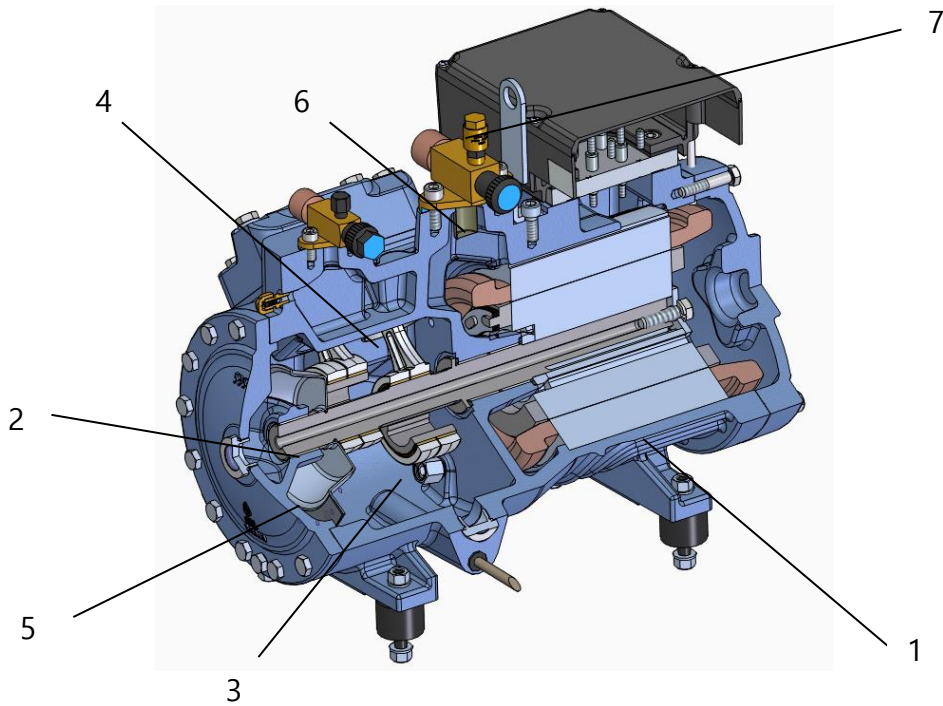

Fig. 6 - Model SPS41 (splasher lubrication)

- | | | |
|---------------------|-------------------------|-------------------|
| 1) Electrical motor | 4) Piston | 6) Suction filter |
| 2) Shaft | 5) Oil centrifugal disk | 7) Safety valve |
| 3) Connecting rod | | |



2.6.3 Compressors with splasher lubrication (SPS42)

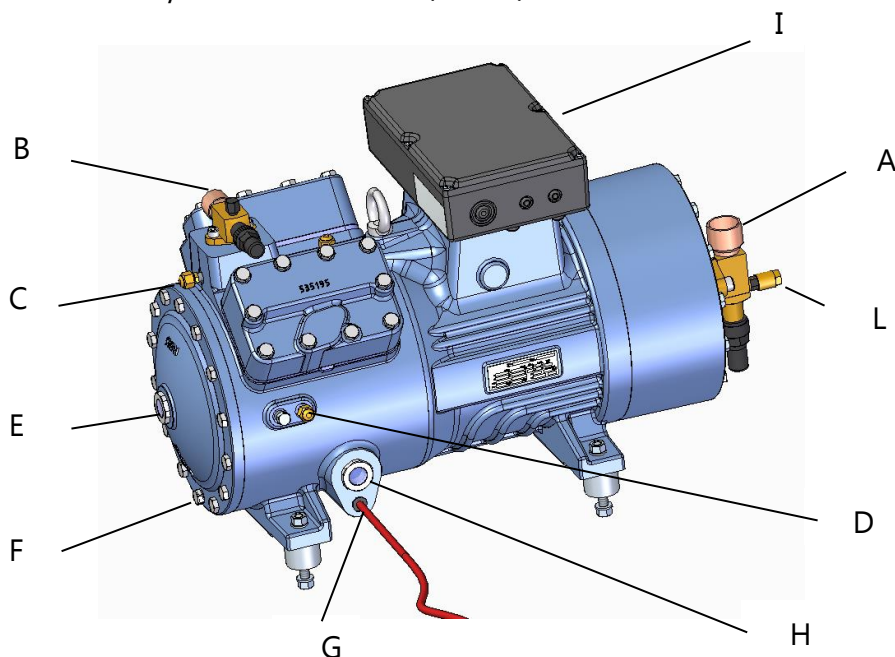

Fig. 7 - Model SPS42 (splasher lubrication)

- | | | |
|-------------------------------------|---------------------------|--------------------------|
| A) Suction shut-off valve | E) Optical oil sensor cap | H) Oil level sight glass |
| B) Discharge shut-off valve | F) Oil discharge | I) Electrical box |
| C) Discharge temperature connection | G) Crankcase heater | L) Safety Valve |
| D) Low pressure connection | | |

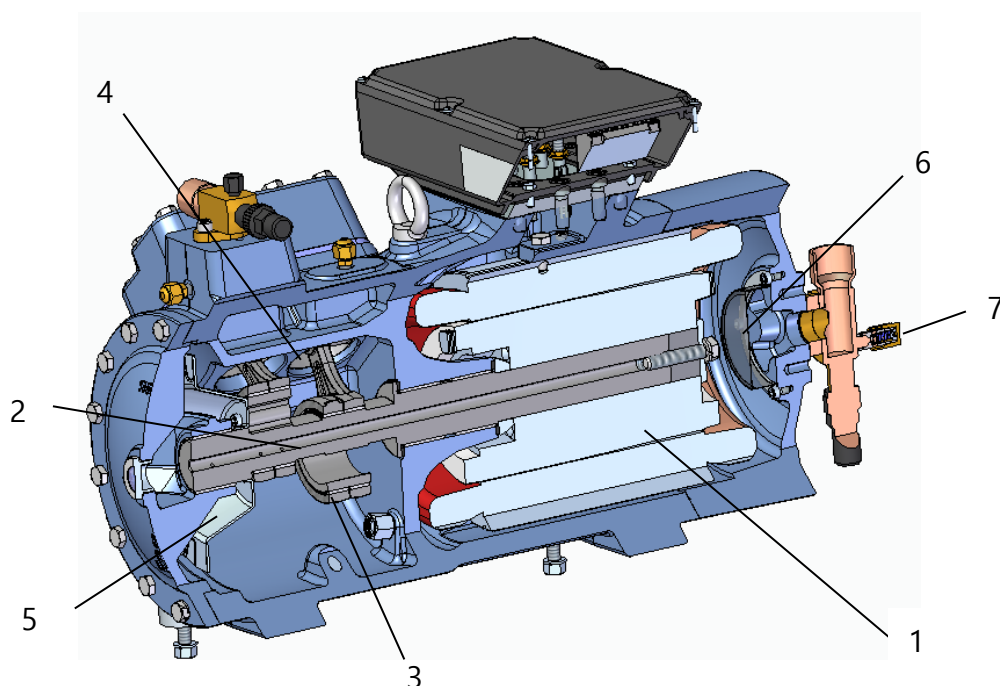

Fig. 8 - Model SPS42 (splasher lubrication)

- | | | |
|---------------------|-------------------------|-------------------|
| 1) Electrical motor | 4) Piston | 6) Suction filter |
| 2) Shaft | 5) Oil centrifugal disk | 7) Safety valve |
| 3) Connecting rod | | |



3 LUBRICATION

3.1 Lubrication systems

The oil has the following functions:

- ✓ couplings lubrication;
- ✓ cooling;
- ✓ vibrations damping;
- ✓ cleaning;
- ✓ sealing between the compression chambers.

The SPS compressors are fitted with splasher lubrication systems: the lubricant is moved through a disk and circulation of oil through centrifugal effect.

3.2 Splasher lubrication

The oil circulation from the oil sump to the different points that have to be lubricated is due only to the centrifugal effect in the oil distribution channels inside the shaft.

The relative low pressure generated in such way is extremely stable and reliable: the geometry of the bushings and of their holes allow, in any case, the formation of an oil film and the consequent hydrodynamic support effect of the relative moving surfaces.

A cross section of a compressor model with splasher lubrication is shown in the Fig. 9.

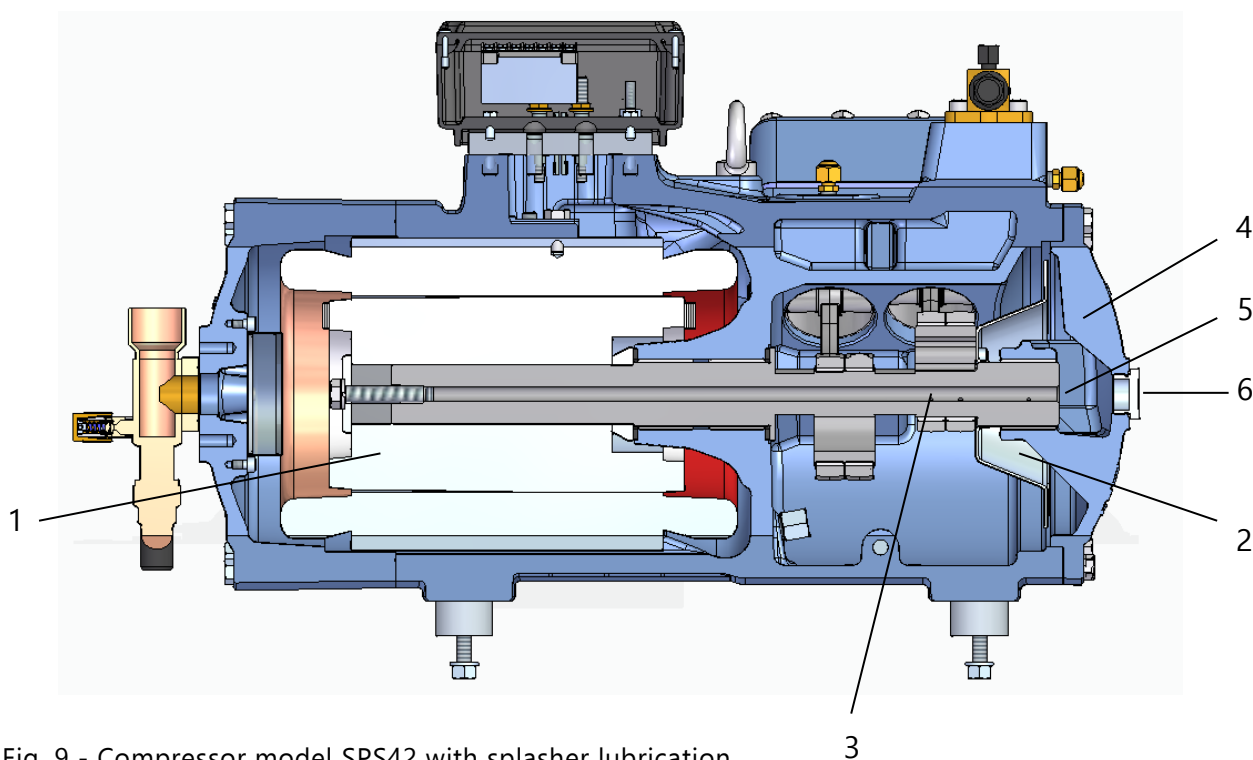

Fig. 9 - Compressor model SPS42 with splasher lubrication

- | | |
|------------------------------|----------------------------------|
| 1) Shaft | 4) Oil sump |
| 2) Centrifugal disk | 5) Oil inlet to the main channel |
| 3) Oil distribution channels | 6) Oil sensor connection |



The oil is moved from the carter to the oil sump, machined inside the cover casing, by a centrifugal disk, properly shaped. Different channels are realized inside the crankshaft to obtain the right lubrication: the central one (coaxial with the shaft) is directly connected to the oil sump, while the other ones (perpendicular to the shaft) grant the lubrication of the sleeve bearings between casing and shaft in suction and discharge side and of the coupling surfaces between crankshaft and connecting rod.

The splasher lubrication is characterized by:

- ✓ greater simplicity and construction reliability thanks to fewer moving parts;
- ✓ greater stability and security of lubrication, even in the early stages of starting the compressor;
- ✓ oil drag reduction, thanks to the oil flow rate towards the lubrication points closely related to the actual demand
- ✓ reduce foaming problems, thanks to an effective removal of oil dissolved in oil

The working principle is the same also for 2-cylinder models

3.3 Crankcase heater

Warning!



The application of the oil heater is permitted only in Zone 2 areas.

Danger of spark formation due to unintended switching operation or overheating of the crankcase oil heater during oil change.



Due to the high oil solubility by the refrigerants, an oil sump heater is strongly suggested.

Switch on the oil heater during standstill operations.

The crankcase heater (option) has the purpose to avoid an excessive dilution of the refrigerant in the oil during the stand still of compressor and has to work when the compressor is not operating.

The crankcase heater shall avoid refrigerant resolving within oil when the compressor is stopped. The crankcase heater of these compressors is PTC type, with auto-regulation of power consumption. The power absorption decreases while the temperature increases obtaining in such way an energy saving, proportional to the size of compressor.

The crankcase heater is assembled in a proper seat, machined on the bottom of the compressor casing (in the same side of the oil sight glass) and closed with a plastic cap.

Warning!



Before starting up for the working season, the heater must be on for at least 24 hours before starting the compressor.



3.3.1 Oil heater assembly procedure

- Hole seat type

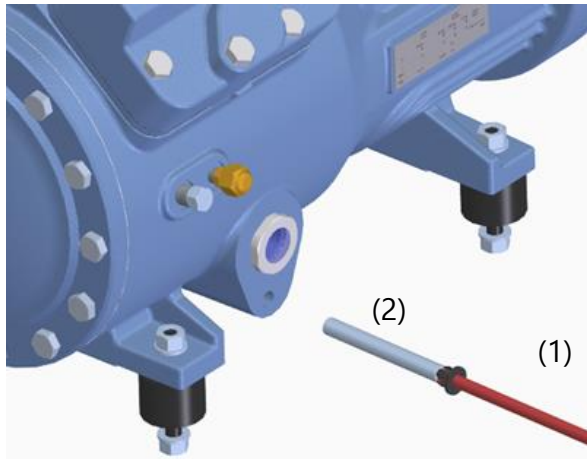

Assembling:

- Insert the heater (2);
- Insert the plastic sealing (1).

Disassembling / Replacement:

- Remove the plastic sealing plug (1);
- Extract the heater (2).

3.4 Oil sight glass

The compressor is filled with lubricant in the standard delivery configuration. Check the compressor oil level by the oil sight glass beside the crankcase oil groove.

Ensure the normal oil level during normal compressor operation, generally between the minimum oil level of the compressor (about 1/3) and the maximum oil level of the compressor (about 2/3).

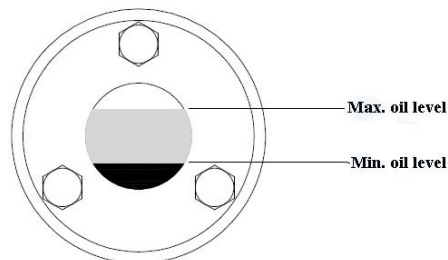

Fig. 10 - Oil monitoring through sight glass

3.5 Electronic oil level switch

The electronic oil level switch is used to monitor the oil level in the compressor to ensure that the working parts of the compressor can be fully lubricated. It is suitable for compressor models with splash lubrication and can be installed directly on flange.



Fig. 11 - Opto-electronic oil level sensor

3.6 Anti-foaming valves

All models are equipped with a check valve between suction line and oil carter (see Fig. 12). These valves are closed during transient states, preventing the equalization of the suction pressure and carter pressure and the consequent foaming.

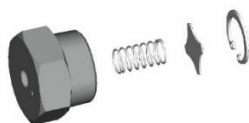

Fig. 12 - Exploded of check valve

3.7 Lubricant of the compressor

The lubricant shall meet the following requirements:

- ✓ Ensure bushings lubrication;
- ✓ Viscosity of oil under nominal operating conditions;
- ✓ Miscibility with refrigerant at low temperature



WARNING:

Only use lubricants which are released by RefComp; lubricants are highly hygroscopic, prevent contact with (humid) air.

In normal operation, some lubricant will remain in the refrigeration system.

There is usually some lubricant in the piping of the refrigeration system, so that the oil level of the compressor oil sight glass will decrease. Dependent on the pipe length and design approx.. 10% more lubricant should be filled to the refrigeration system if necessary.

If the refrigeration system is equipped with an oil separator, also consider the amount of lubricant to be charged into the oil separator.

After commissioning check the oil level of oil sight glass regularly until stable conditions prevail.

The compressor oil level needs to be measured when the compressor is running stable.

After 300 hours of stable operation check the properties of the oil:

- ✓ Colour
- ✓ Odour
- ✓ Kinematic viscosity
- ✓ Humidity
- ✓ PH of the system
- ✓ The oil composition.

If the oil colour has changed, consider a change of oil.



4 COMPONENTS

4.1 Suction filter

All models are equipped with suction filter which can be inspected and cleaned only dismounting suction shut-off valve. Fig. 13 shows the position of suction filter in SPS21/22 models.

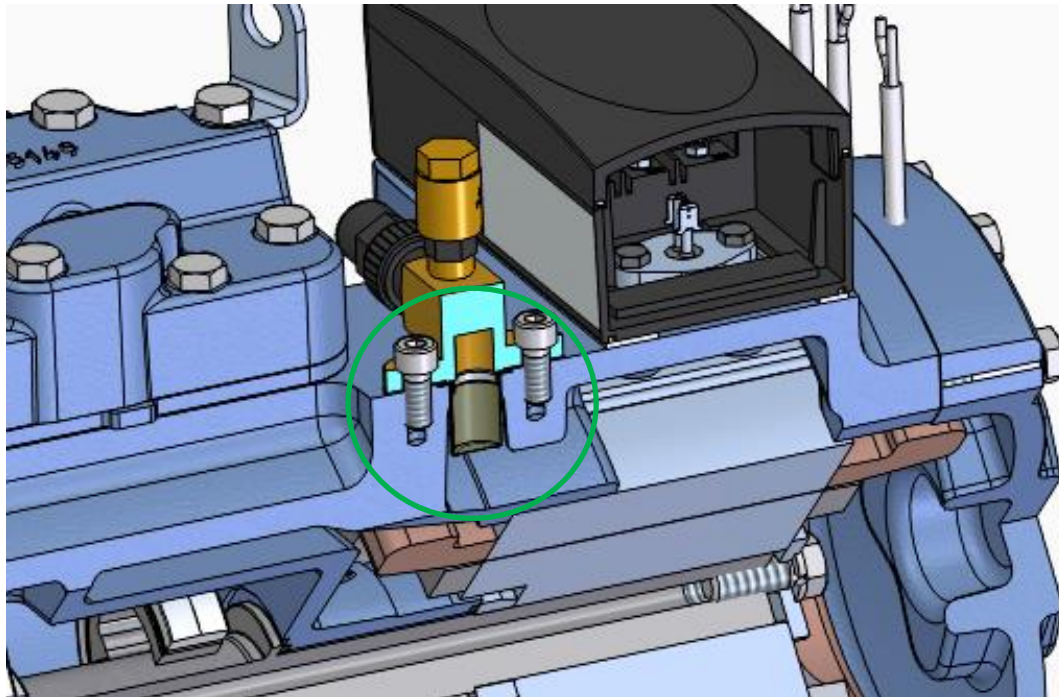

Fig. 13 - Position of suction filter for SPS21/22 models

4.2 Shut-off valves - Pipes connection

The tables below show the type of shut-off valves mounted on the compressors, with reference to the types indicated on paragraph 6.1.

Suction and discharge sides don't require flexible pipes.

Suction and discharge pipes should not transmit stresses to compressors.

Use only pipes and components thoroughly clean and free of humidity, without waste, scrap, rust and phosphate coating.

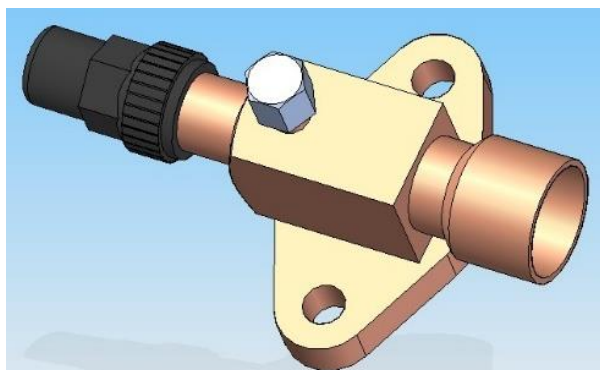

Fig. 14 - Valve types

4.3 Shaft and connecting rods

SPS Series are equipped with a balanced shaft using proper weights. For 2 and 4-cylinder models SPS21/22 and SPS41/42, the balancing weight is fixed to the shaft during the assembling phase with screws (see Fig. 16).

4.3.1 Compressor models SPS21/22 and SPS41/42

The connecting rod for these compressors is realized in a single component (see Fig. 15), so the assembling is realized by moving the dial along the shaft until it reaches the correct position at the working cylinder.

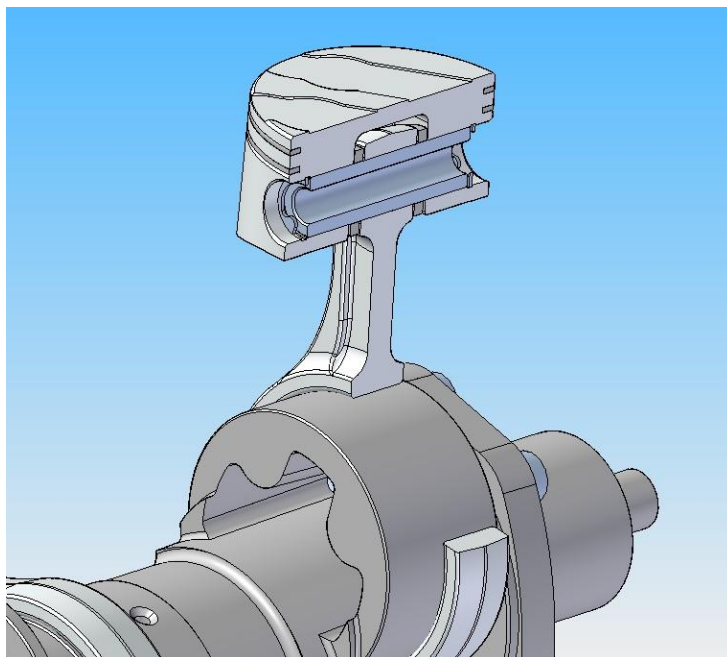

Fig. 15 - Connecting rod for compressor models SPS21/22 and SPS41/42,

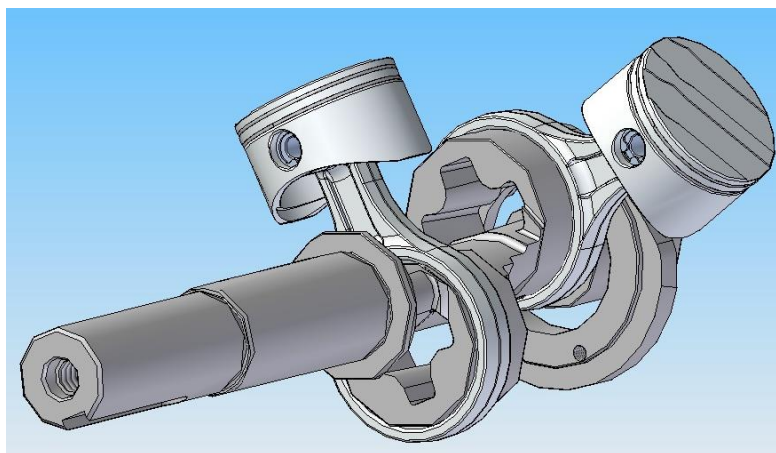

Fig. 16 - Motor shaft and connecting rod for SPS21/22 and SPS41/42

4.4 Pistons

The pistons are mounted with sealing/scrapper rings as showed in the picture below. It's necessary to assemble the scraper rings (rif. 4 in Fig. 17) in the correct direction, with the writing "TOP" up.

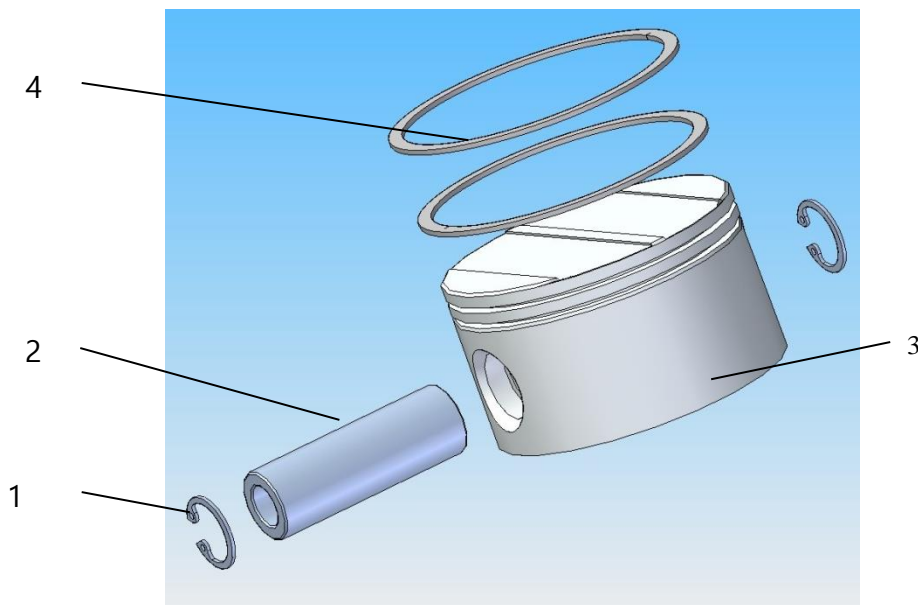

Fig. 17 - Piston

1)Seeger ring
2)Pivot

3)Piston
4)Scrapper ring

4.5 Valve plates

The valve plates differs according to cylinder size and components layout; the Tab. 5 show the valve plate type related to compressor models.

In the pictures of Tab. 5 it can be seen also the suction (A) and the discharge (B) holes.

A gasket is assembled in the lower surface to divide the high and low pressures avoiding by-pass between pistons. Another gasket is assembled in the upper side in order to separate low pressure side (Suction) from high pressure side (Delivery).

To assemble the valve plate, follow the procedure below:

- Install the proper gasket on the compressor casing (the gasket shows part of the profiles of the intake valves)
- Position the face indicated as "lower side" versus the compressor.
- For the torque of the locking screws of the head please contact RefComp.
- The plate valves and valves do not need maintenance

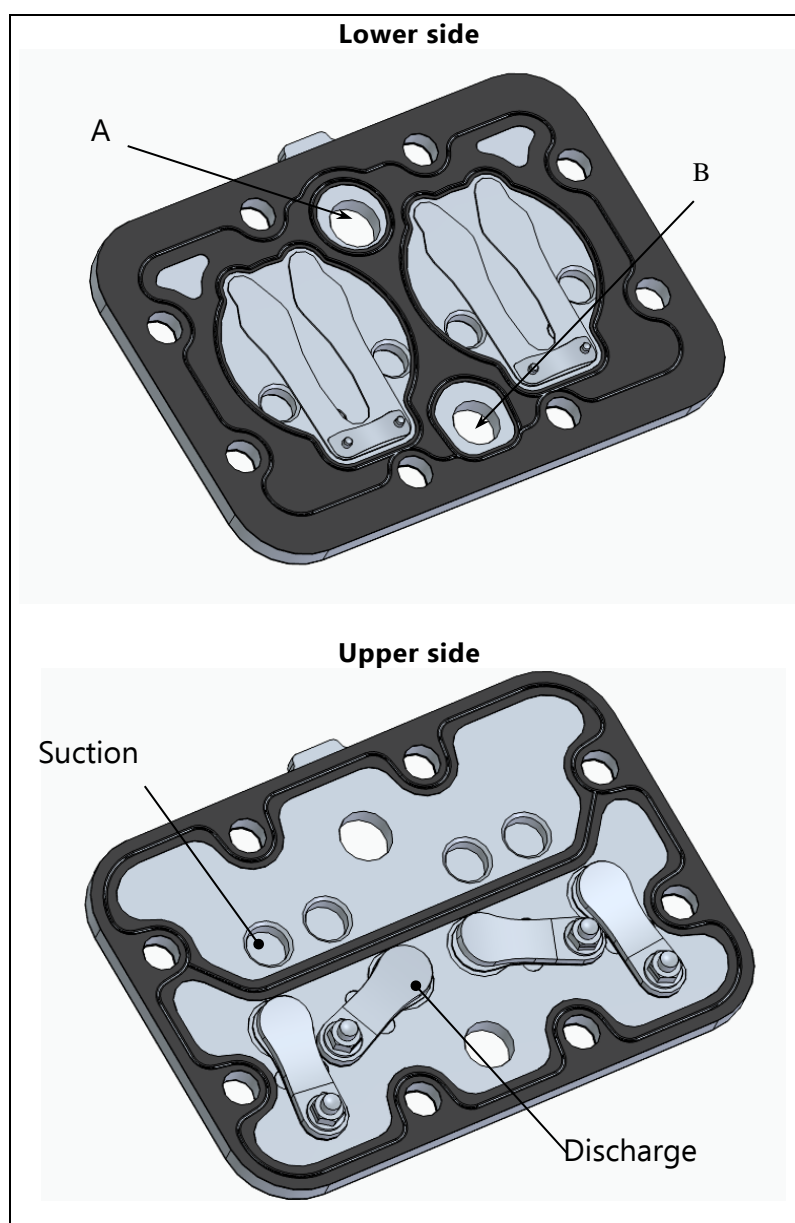

Tab. 5 - Valve plate types



Warning!

To mount the plate is not necessary to use force; all the pieces must match in a natural way.

Carefully control the cleaning the plate, especially at the surfaces of the valves. If necessary, clean with a clean paper (do not touch these parts with the metal).



4.6 Sleeve bearings

The crankshaft is supported by lubricated sleeve bearing on two sides: casing and splashing cover.

The sleeve bearings in the casing case are two and fitted as shown in Fig. 18, while on the splashing cover is single and assembled as shown in Fig. 19

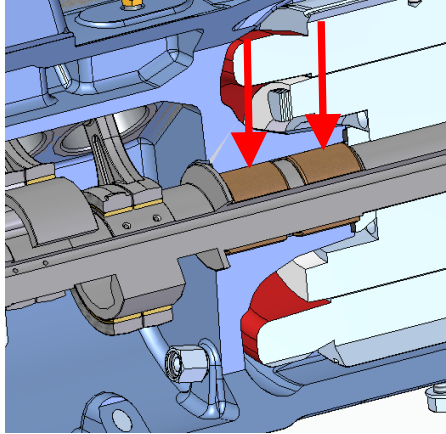

Fig. 18 - Bushing assembly on motor side

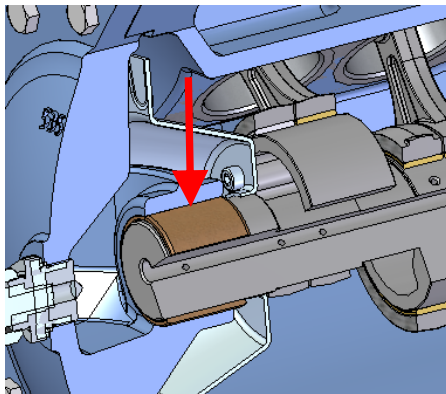

Fig. 19 - Bushing assembly on splashing covers side

4.7 Thrust bearing washer

The compressors are equipped with thrust bearing washer; these are assembled in the casing in the motor shaft support and in splashing cover side.

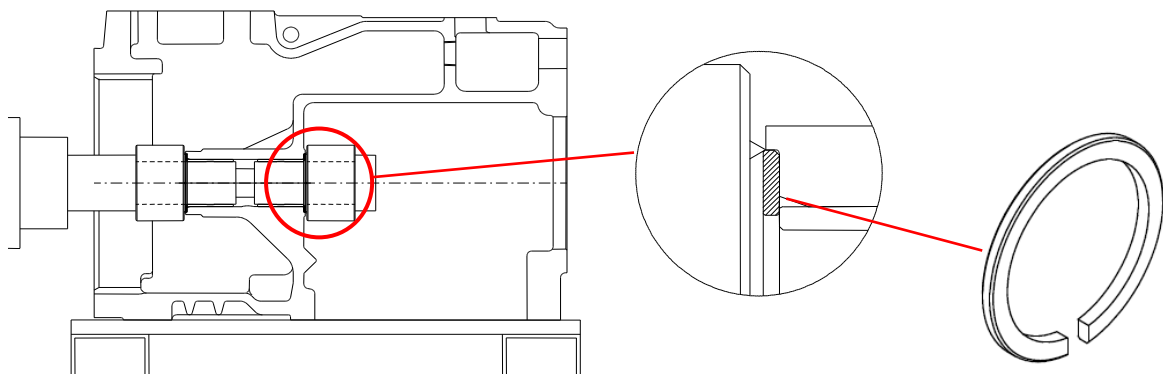

Fig. 20 - Thrust bearing washer assembly

5.3 Motor thermistor

To protect the motor, six PTC thermistors are woven into the compressor motor windings: three of them are placed on the suction side of the compressor with a switch-off temperature is 100 ° C; the other three are placed on the discharge side of the compressor with a switch-off temperature of 120 ° C.

When the temperature is lower than 40 ° C, the resistance value of the thermistor chain should not exceed 1800Ω. If the temperature of one thermistor exceeds a critical value, the resistance value of the resistor will increase exponentially. The compressor motor power is cut off by the protection module INT69B2. The resistance value of the resistance chain can be measured according to the resistance terminals T1 and T2 in the electrical box

5.4 Electrical box

The protection degree of electrical box is IP54. This protection is achieved if all the gaskets, seals and connections are properly installed after the installation of electric cables.

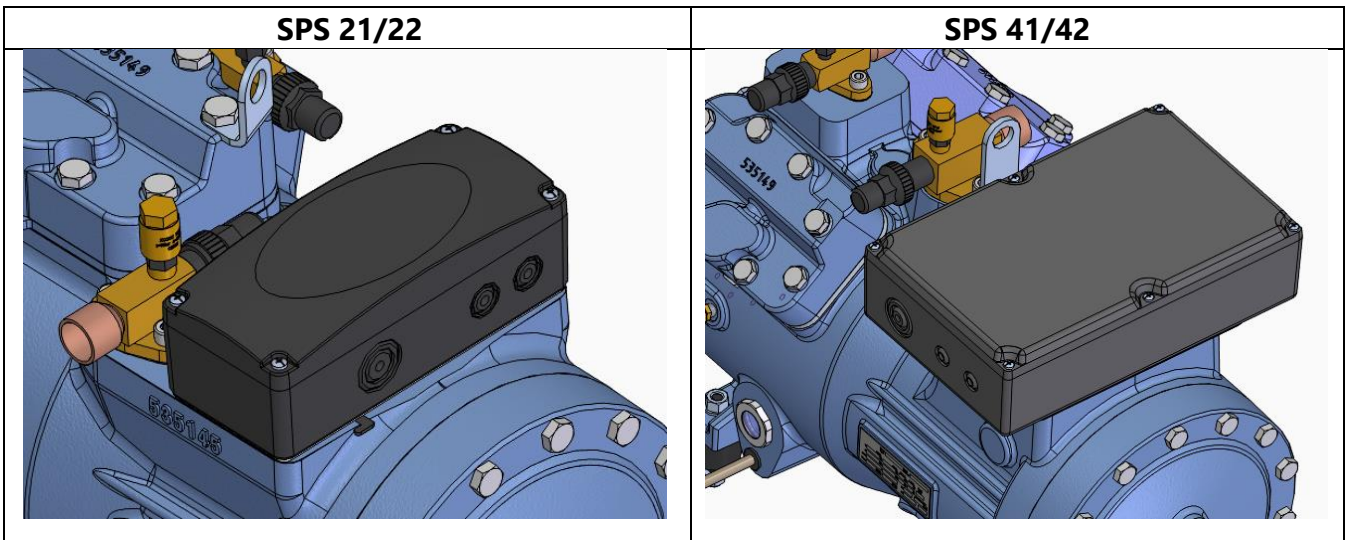

Fig. 22 – Electrical Boxes SPS 21/22, SPS 41/42



5.5 Terminal board

The terminal board inside the electrical box has 6 terminals connected with electrical motor. These 6 terminals are insulated with glass inserts from the metallic parts and, in the upper part, the glass is coated with rubber insulation and prevents any condensation which, touching the same terminal, could cause a short circuit. During the maintenance operations must make sure that the rubber that has not been damaged. During routine maintenance is necessary to verify the tightness of the cables.

The direction of rotation is not important, so the power supply connection hasn't a right direction. It's enough to verify that:

- the first phase is connected to terminals 1-7
- the second phase is connected to terminals 2-8
- the third phase is connected to terminals 3-9

The electric motor, if necessary, can also be used with direct starting (DOL). To do so can be used bonds between pin 1-7, 2-8 and 3-9 of the terminal boards as shown in Picture 5 6. The bonds for the direct starting are provided with the compressor, as a separate kit.

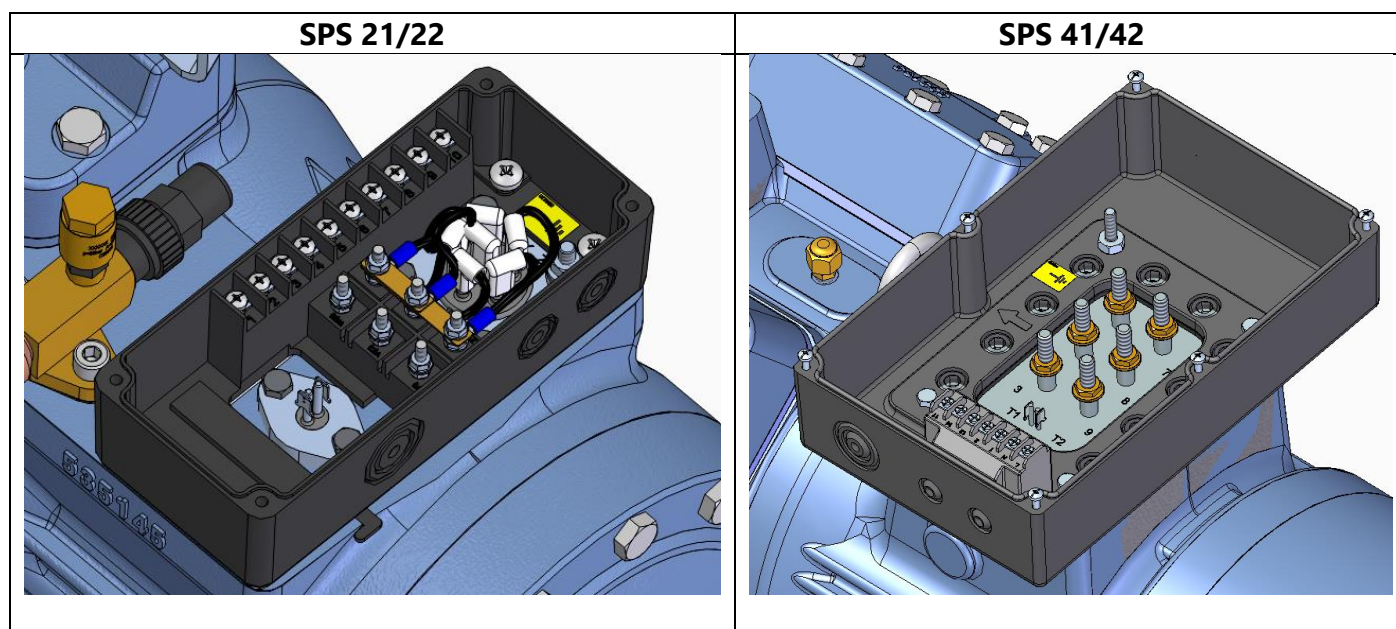

Fig. 23 Bonds on terminal board

6 DATA

6.1 Technical data

model	Displacement	Nr. Cylinder.	suction valve	discharge valve	motor conn.	max working current F.L.A.	max power consump.	Starting current L.R.A.	Weight	Oil charge
	50Hz		inch	inch	volt	A	kW	A	Kg	Lt.
SPS21-1.5	1,5	2	5/8	1/2	Δ / Y Δ : 220-240V - 3 - 50Hz; 265-290V - 3 - 60HZ Y: 380-420V - 3 - 50Hz; 440-480V - 3 - 60HZ	4,2 / 2,4	1,1	16,4 / 9,4	47	1,0
SPS21-2	1,8	2	5/8	1/2		4,8 / 2,8	1,2	16,4 / 9,4	47	1,0
SPS21-2.5	2,3	2	5/8	1/2		6,0 / 3,4	1,5	26,4 / 15,2	48	1,0
SPS21-3	2,8	2	5/8	1/2		6,8 / 3,9	1,9	26,4 / 15,2	48	1,0
SPS21-3.5	3,6	2	5/8	1/2		8,5 / 4,9	2,5	43,5 / 25,0	50	1,0
SPS21-4.5	4,5	2	5/8	1/2		9,9 / 5,7	3,1	43,5 / 25,0	50	1,0
SPS21-5.5	5,5	2	5/8	1/2		13,3 / 7,6	4,0	66,6 / 38,2	52	1,0
SPS21-6.5	6,7	2	5/8	1/2		16,1 / 9,3	4,8	66,6 / 38,2	52	1,0
SPS22-8	7,8	2	7/8	5/8		17,5 / 10,1	5,5	79,2 / 45,8	78	1,2
SPS22-9	9,2	2	7/8	5/8		20,1 / 11,5	6,4	96,1 / 55,5	80	1,2
SPS22-11	11,2	2	7/8	5/8		24,7 / 14,2	7,8	123,7 / 71,5	84	1,2
SPS41-13	13,0	4	1 1/8	5/8		29,6 / 17,0	8,8	161,7 / 93,5	97	1,8
SPS41-15	15,6	4	1 1/8	5/8		33,7 / 19,4	10,7	203,8 / 117,8	98	1,8
SPS41-18	18,4	4	1 1/8	7/8		39,3 / 22,6	12,7	235,2 / 136	103	1,8
SPS41-22	22,3	4	1 1/8	7/8	47,6 / 27,4	15,5	235,2 / 136	103	1,8	
SPS42-29	28,7	4	1 1/8	7/8	PW (Y/YY) 380-420V - 3 - 50Hz 440-480V - 3 - 60Hz	33,3	19,5	121 / 198	158	2,4
SPS42-35	34,7	4	1 3/8	1 1/8		40,4	23,7	162 / 265	162	2,4
SPS42-41	41,3	4	1 3/8	1 1/8		49,4	28,4	185 / 303	172	2,4
SPS42-48	48,5	4	1 3/8	1 1/8		57,4	33,6	215 / 352	175	2,4

Tab. 6 – Technical data

7 DIMENSIONAL DRAWINGS AND PACKAGING

7.1 Dimensional drawings

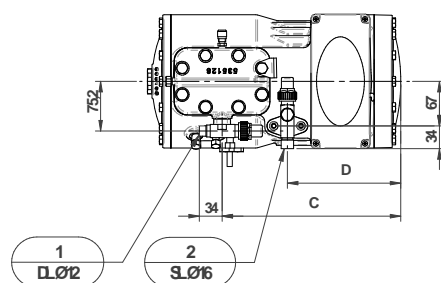
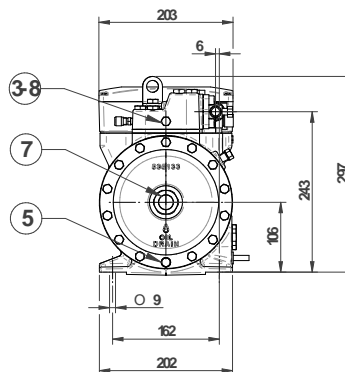
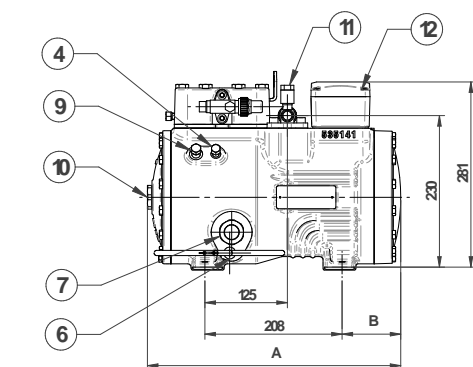

Type	A	B	C	D
SFS21-15	373	77	259	160
SFS21-2	373	77	259	160
SFS21-25	373	77	259	160
SFS21-3	373	77	259	160
SFS21-35	373	77	259	160
SFS21-45	384	89	271	172
SFS21-55	384	89	271	172
SFS21-65	384	89	271	172

- Key:
- 1) Suction shut-off valve
 - 2) Discharge shut-off valve
 - 3) High pressure 1/8"-27NPT
 - 4) Low pressure 1/8"-27 NPT
 - 5) Oil drain M8x15
 - 6) Crankcase heater
 - 7) Oil sight glass 1 1/8"- 18UNF
 - 8) Discharge temperature sensor 1/8"NPT (Qt)
 - 9) Oil charging 1/4"- 18 NPT (Optional)
 - 10) Oil level sensor (optional)
 - 11) Safety Valve 6Mpa
 - 12) Connection Box

SFS21-15; SFS21-2; SFS21-25; SFS21-3;
SFS21-35; SFS21-45; SFS21-55; SFS21-65;

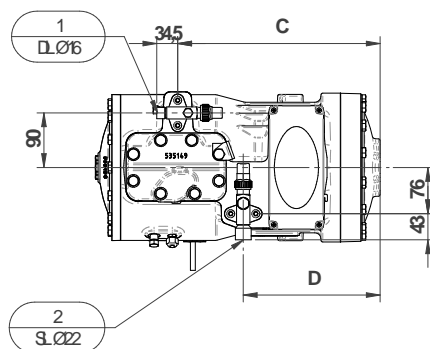
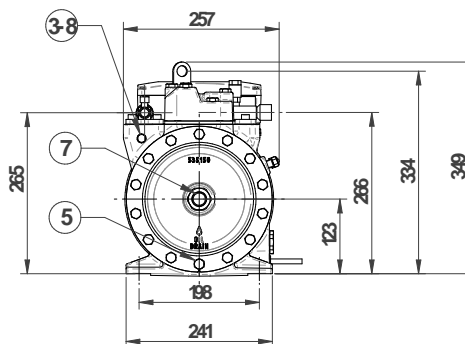
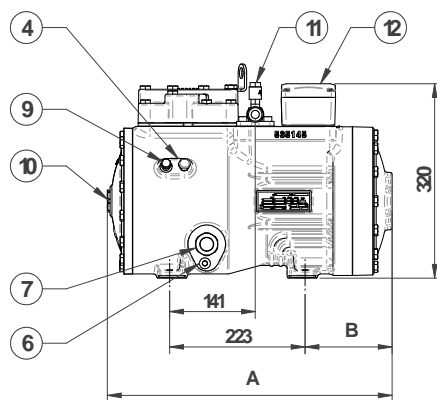

Type	A	B	C	D
SFS22-8	439	113	303	195
SFS22-9	439	113	303	195
SFS22-11	469	143	333	225

- Key:
- 1) Suction shut-off valve
 - 2) Discharge shut-off valve
 - 3) High pressure 1/8"-27NPT
 - 4) Low pressure 1/8"-27 NPT
 - 5) Oil drain M8x15
 - 6) Crankcase heater
 - 7) Oil sight glass 1 1/8"- 18UNF
 - 8) Discharge temperature sensor 1/8"NPT (Qt)
 - 9) Oil charging 1/4"- 18 NPT (Optional)
 - 10) Oil level sensor (optional)
 - 11) Safety Valve 6Mpa
 - 12) Connection Box

SFS22-8; SFS22-9; SFS22-11

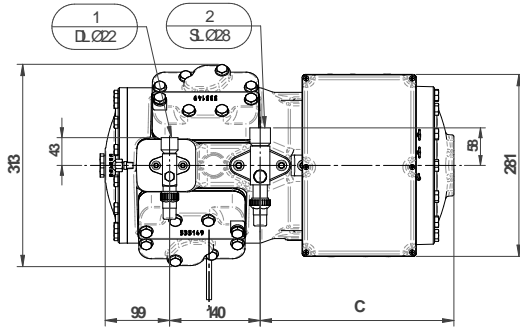
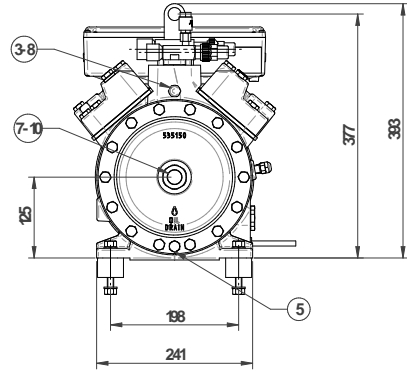
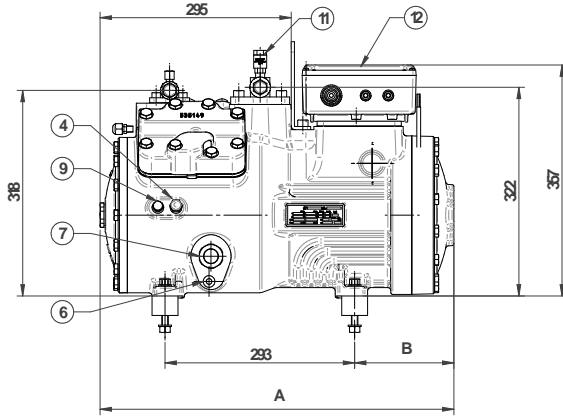

- Key:
- 1) Suction shut-off valve
 - 2) Discharge shut-off valve
 - 3) High pressure 1/8" - 27NPT
 - 4) Low pressure 1/8" - 27 NPT
 - 5) Oil drain M8x15
 - 6) Crankcase heater
 - 7) Oil sight glass 1 1/8" - 18UNF
 - 8) Discharge temperature sensor 1/8"NPT (Opt)
 - 9) Oil charging 1/4" - 18 NPT (optional)
 - 10) Oil level sensor (optional)
 - 11) Safety Valve M24-16MPa
 - 12) Connection Box

Type	A	B	C
SFSH-13	58	23	289
SFSH-15	58	23	289
SFSH-18	58	23	289
SFSH-22	58	23	289

SFSH-13; SFSH-15; SFSH-18; SFSH-22;

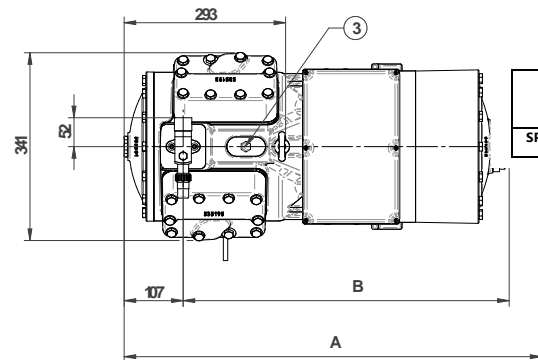
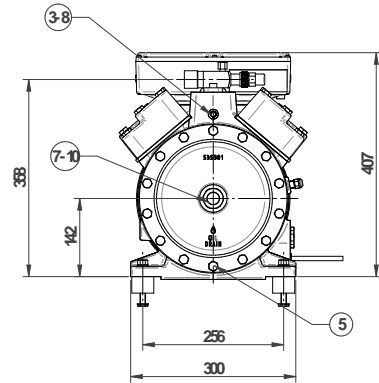
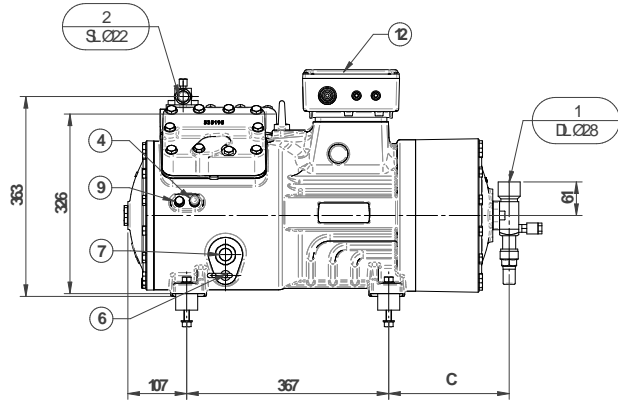

- Key:
- 1) Suction shut-off valve
 - 2) Discharge shut-off valve
 - 3) High pressure 1/8" - 27NPT

Modello / Type	SL=Ø [mm (")]	DL=Ø [mm (")]
SPS42-41; SPS42-48	28	22

- 11) Safety Valve 60MPa
12) Connection Box

Type	A	B	C
SFSI2-29	760	534	160
SFSI2-35	760	534	160
SFSI2-41	830	594	220
SFSI2-48	830	594	220

SFSI2-13; SFSI2-35; SFSI2-41; SFSI2-48



7.2 Packaging

Compressors models SPS21/22 and SPS41/42x are packed individually using wooden pallets with corrugated cardboard for packaging, as shown in Fig. 24.

The compressor is fixed to the pallet with 4 bolts (Fig. 26).

The type of corrugated cardboard is suitable for transport by sea, with a thickness of 9.4 mm and structure (combination wave) AA. The carton is guaranteed by the absence of separation of layers after 24 hours in water.

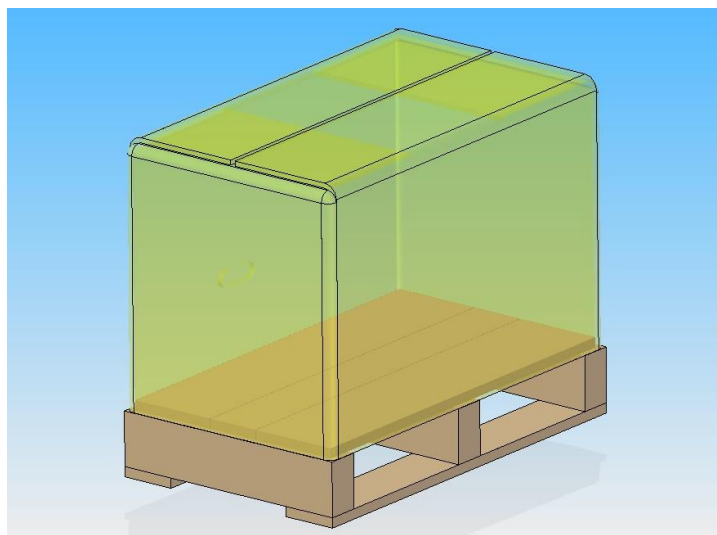

Fig. 24 Packing with carton box

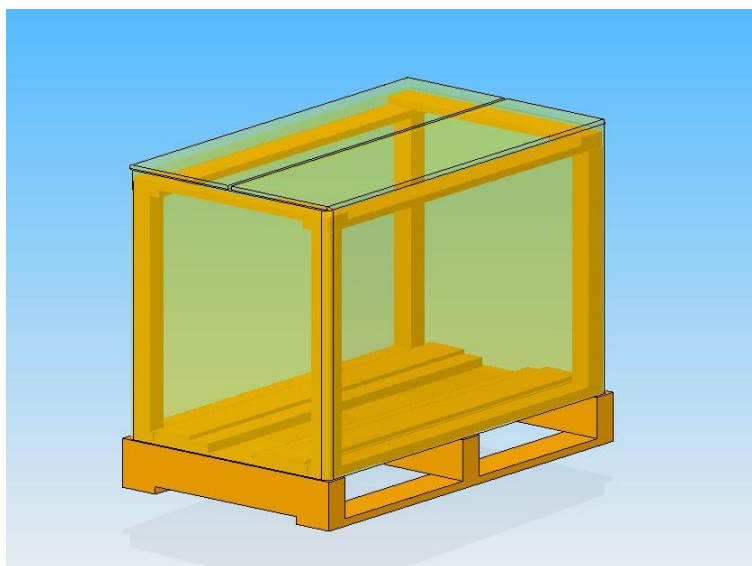

Fig. 25 Packing with reinforced structure

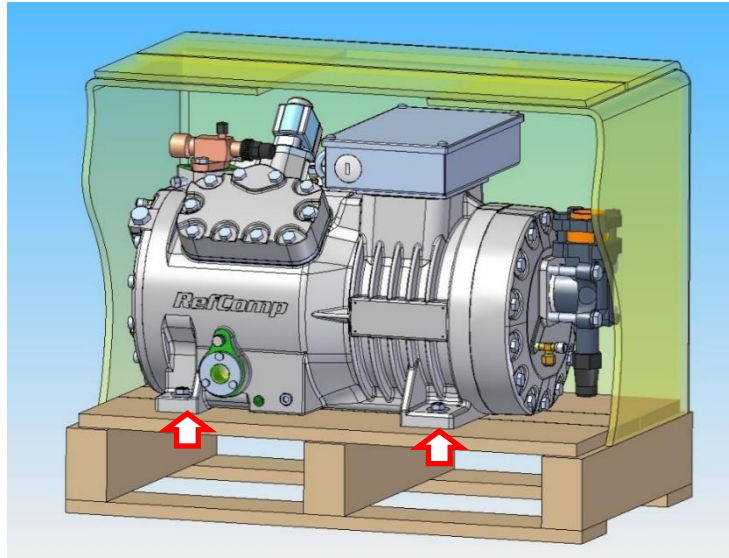

Fig. 26 Compressor fixed to the pallet through screws

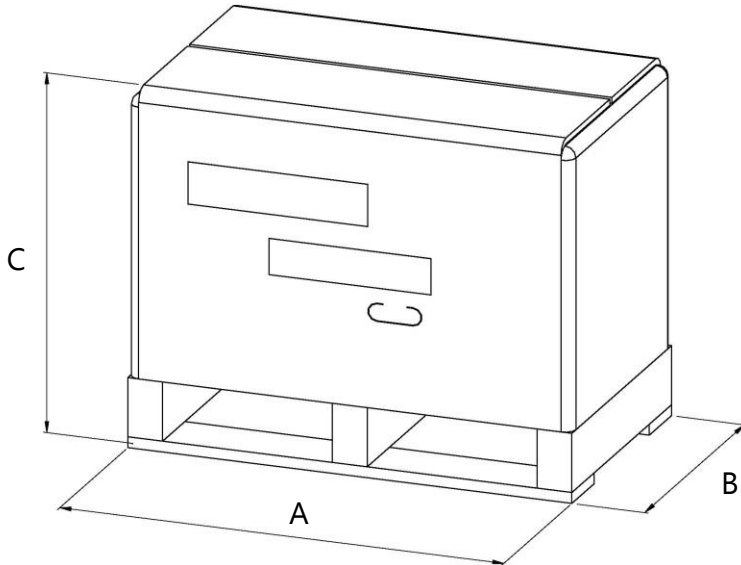

Fig. 27 Dimensions for packing of SP Series

Model	A [mm]	B [mm]	C [mm]
SPS21/22	610	340	478
SPS41	740	440	600
SPS42	870	670	729

Tab. 7 - Packages dimensions

Warning!



Compressors have to be moved or lifted with a forklift truck with special equipment carried out by trained personnel. The shipping weights of the various compressors (compressors should be considered in the standard configuration) are listed in the Tab. 6. For deeper information see Chapter 12 "Extent of delivery").



8 TRANSPORT, HANDLING AND STORAGE

8.1 Receiving and unpacking

Upon receipt of the compressor, after removing the upper part of the package, make sure that no damages occurred during transport. If you notice damage due to transport, please provide to make a written complaint, possibly accompanied with photos of the damaged parts, to your insurance company and send copies to the Manufacturer and transporter. For the entire period that the compressor is not used, before unpacking it, store in a dry place at a temperature between + 5 ° C and + 45 ° C and in position to avoid contact with atmospheric agents.

For the entire period that the compressor is not used, after being unpacked, before first start-up or for long period unused, you need to change the oil and check the operation.

If the compressor is not used for long periods, you need to change the oil and check the operation.



Please dispose of the packaging according to the different types of material in full compliance with the legislation in force in the country of use.

8.2 Transport & Handling

It should be distinguished two types of transport: the packaging of the compressor and of the compressor installed on the refrigeration unit mounted with spring vibration damper.

8.2.1 Carriage of packaged compressor

In the case of transportation of the compressor in the package, it should take care that the transport doesn't cause impacts and vibrations on the compressor to avoid the breakaway of the compressor itself from the pallet. A transport carried out on unpaved roads could cause the damage botL of the packing and of the compressors.



The transport of the packed compressor must be operated by qualified personnel using a forklift truck.



ATTENTION: before making any transport operations, make sure that the lift capacity is suitable for the load to be lifted.

Place the forks exclusively in the pallet bottom. After positioning the forks at the points indicated, lift slowly without sudden movements.



With the usage of a forklift, bring the compressor as close as possible to the place to install, then carefully remove the protective packing, paying attention not to damage it, and follow the instructions below:

- Remove the carton.
- Remove the screws that fix compressor to the wooden pallet.



Please dispose of the packaging according to the different types of material in full compliance with current legislation in the country of utilization.



It is mandatory to install the compressor in a ventilated area with proper ventilation to keep the room temperature between +2°C to +40°C, with humidity level between 5 to 95%.



It is mandatory to contact the manufacturer or authorized dealer in the event of an inadequate exhaust of hot air from the place of installation of the compressor.

It is mandatory that the air introduced into the compressor installation site is clean and free of dust, fumes and flammable vapors.

8.3 Storage

If it is necessary to storage the compressor for some time, it's necessary to be very careful at storage height: exceeding the maximum value recommended can lead to accidents (see. Fig. 28)

i The temperature and humidity of storage environment should not be subjected to large variations and the duration of storage should not exceed one year; the package also should be stored in the shade.

- ✓ High variations in temperature and humidity and direct rays of the sun age board causing the degradation of mechanical properties which is particularly dangerous if there is stacking of multiple compressors.
- ✓ The strong cyclical variations in temperature could cause damage on mechanical and plastic parts of the compressor, with a risk of seizing to the next start up

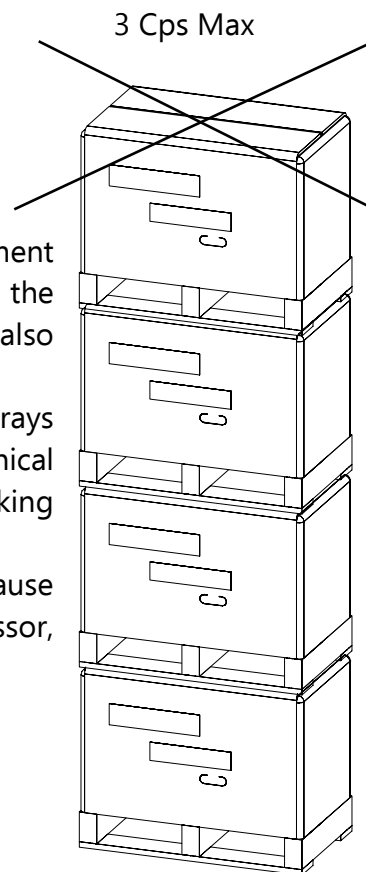

Fig. 28 Maximum storage height allowed

8.4 Handling and lifting



The transport of the packed compressor must be operated by qualified personnel using a forklift truck.



ATTENTION: before making any transport operations, make sure that the lift capacity is suitable for the load to be lifted.

Due to their weight the compressor must be handled with appropriate equipment and for safety reasons must be lifted using the appropriate lugs as shown in Fig. 29.

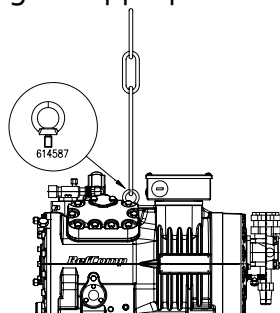

Fig. 29 Lifting instructions



9 APPLICATION RANGE

9.1 General

The normal admissible operating conditions for the SPS series compressors, with changes in evaporation and condensing temperature, are defined by a polygon. The entire field of operation of the compressor is divided into different areas, featuring special precautions that must be adopted so as to ensure correct operation. For details, check the catalogue and the "RefComp" selection software.

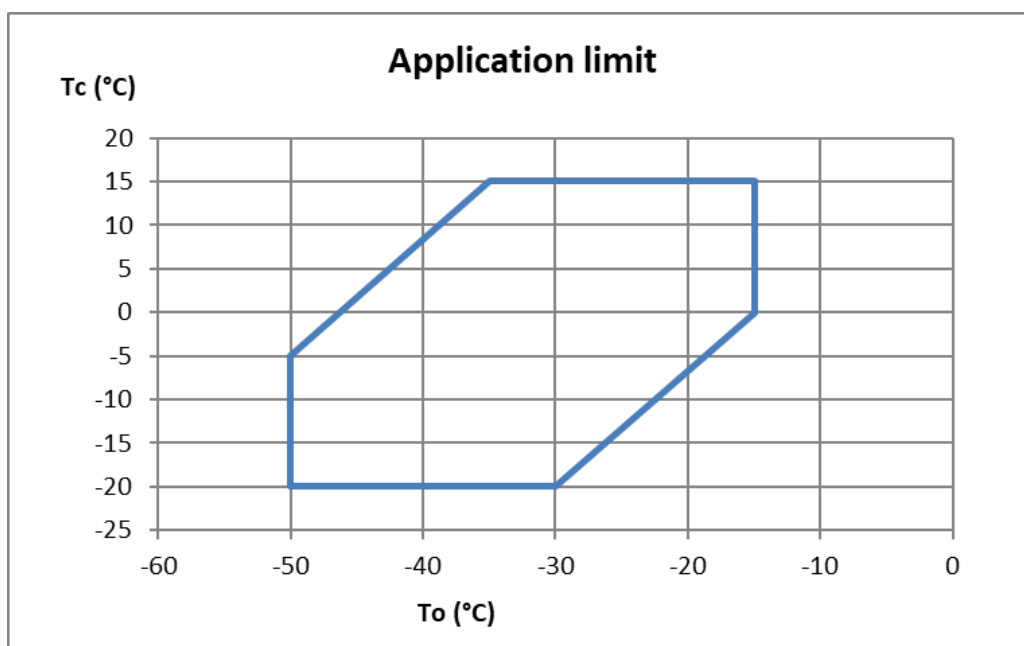

Fig. 30 – Application range



WARNING:

The compressor must not be operated outside of application limit



10 OPERATIVE INSTRUCTION

10.1 Compressor requirements

RefComp Compressors can only work with refrigerants allowed by RefComp and cannot, in any case, work with air or other gases. In particular, if they work with air, there is risk of spontaneous explosion, because of the mixture of air and oil which, if the compression ratio reaches values close to 1:15 (pressure evaporation / condensation pressure, relative), triggers a mechanism of self-ignition and explosion. This effect is called "EFFECT DIESEL" and it's probably is higher as closer is the discharge shut-off valve.

Never start the compressor, if the suction and discharge shut-off valves are not fully opened and the terminal box cover correctly fitted and fixed.

While the compressor is running, do not operate with the suction and discharge valves, do not remove the terminal box cover

To seal the pressure of the refrigerant circuits, use only nitrogen or carbon dioxide, and never use oxygen or acetylene.

The compressor can never be put into operation if it is not connected to the circuit.

During operation, the compressor surface can reach temperatures greater than 100 ° C and below 0 ° C.



WARNING !

The staff is required to wear appropriate personal protective equipment (safety footwear, overalls, gloves, goggles and mask).



WARNING !

Work on electrical equipment should be performed in the absence of tension, only by a qualified electrician.



WARNING !

All maintenance operations must be performed with standstill compressor without power supply, after opening of the switch cabinet or detachment of the plug from the factory.



WARNING !

The maintenance, inspection and regulation should be performed only by qualified personnel with appropriate personal protective equipment (safety footwear, overalls, gloves, glasses and mask), tools and auxiliary equipment suitable (if necessary).



WARNING !

If the maintenance is on the Mechanical parts of the machine the power switch has to be opened (par. 1.5).



WARNING !



The machine and the work area must be secured against access by outsiders !



WARNING !

If operations of circuit breakers (motor circuit breakers, circuit breakers or differential) occur repeatedly (2 or more times in a row), it is essential to be warned and/or call a qualified electrician.

In cases of burns fuses and circuit breakers work is always suggested to identify and eliminate the cause that caused the trouble, since the replacement or restoration indiscriminate, in most cases does not solve the problem.

**WARNING !**

It is prohibited to clean electrical equipment using compressed air: danger of damage to electrical components.

**WARNING !**

The cleaning and troubleshooting must be done with stand still compressor and with the electricity supply disconnected

**WARNING !**

The reset switch should be performed only by a qualified electrician, with appropriate personal protective equipment, tools and proper auxiliary equipment.

**WARNING !**

Restore operations op tripped breaker must be with stand still compressor and with the electricity supply disconnected (by removal of the plug from the power plant general).

**WARNING !**

If operations of circuit breakers (breaker, switch or differential) occur repeatedly (2 or more times) it is essential to be warned and / or call a service engineer.

10.2 Installation and commissioning

The following conditions must be met for the installation site:

- The ambient temperature must not be below -15°C or above 50°C .
- The installation site must not show excessive temperature and humidity fluctuations, which can lead to condensation of moisture in the terminal box.
- At the installation site, the electrical attachments may only be exposed to conditions that correspond to and are covered by the specified IP protection class.



WARNING:

The compressor is protected by nitrogen (0.5-1bar above atmospheric pressure) to prevent air from entering the compressor.



WARNING:

Release the nitrogen from the compressor, and then connected the compressor to the refrigeration circuit to ensure no air enters the suction and discharge shut-off valves. The contact time between the inside of the compressor (such as lubricant) and air should not exceed 30 minutes.

10.3 Vibration damper

The compressor must be installed horizontally and with the vibration dampers (elastomer dampers) supplied as standard. These are installed between the compressor feet and the frame profiles.

For rigid connection, please consult with RefComp.

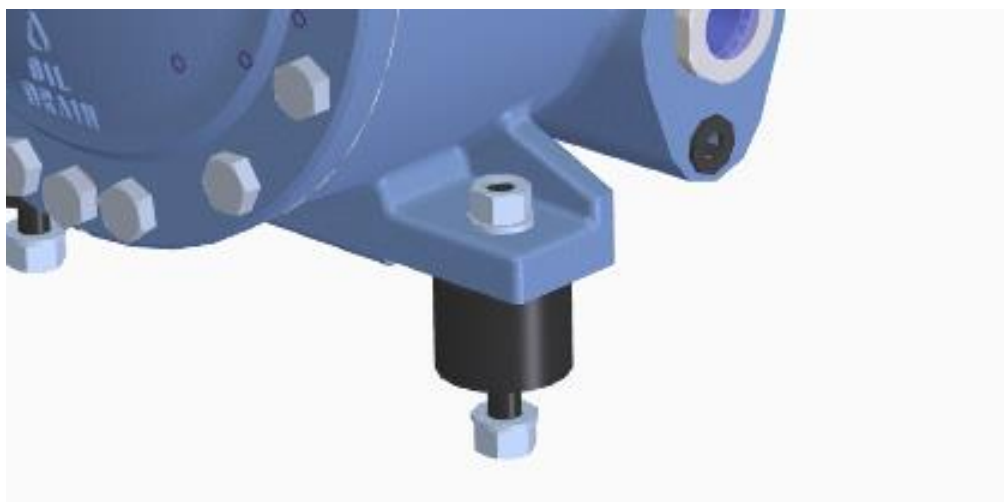

Fig. 31 – Vibration Damper



10.4 Electrical connection

Operate the electrical connection according to the wiring diagrams in the terminal box. Please select the specification of motor contactor, cable and fuse according to the Full Load Amps (FLA). Please check the nameplate for the specific value of FLA. The voltage and frequency of the power supply must be in accordance with the rated voltage on the nameplate. Terminal T1-T2 on the wiring board and terminal 1-2 on the motor protector INT 69, shall not be connected to the power supply.

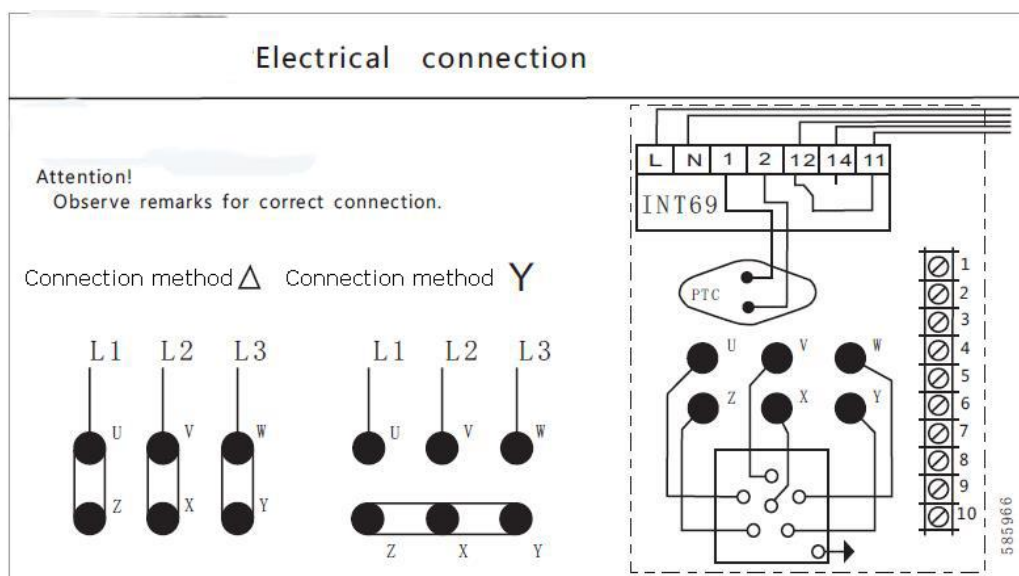

Fig. 32- Y/D connection

10.5 Pressure Switch

The compressor must be equipped with high- and low-pressure switches to control the operating range within the applicable limits.

10.6 Pressure limit

The allowable design pressures are as follow:

	Design pressure
High / Low pressure	60bar

To prevent motor overload, the working pressure must be controlled within the application range. If necessary, M.O.P (maximum operating pressure) expansion valve or pressure regulator is recommended.

Motor overload may occur on occasions of high demand such as re-starting after defrost, overloading of cold storage with products to be pulled down.

Compressors are supplied with a pressure relief valve installed on suction side.



**WARNING:**

Pressure relief valve installed on compressor is not considered as SAFETY VALVE. Safety valves must be installed on plant and designed according the standards and laws of the installation site.

10.7 Temperature limit

Discharge temperature:

- Max.:140°C;
- Min.: Above condensation saturation temperature 30K.

Suction temperature:

- evaporating temperature + superheat. Please check "Application Range" for the evaporating temperature range, and the superheat range is 8 ~ 30K.

10.8 Running time

Number of Start-up:	No more than 6 times per hour
The minimum time between two starts	10 minutes
Minimum running time:	3 minutes

**ATTENTION!**

A number of starts higher than the one suggested may damage the electrical motor and affect the theoretical compressor working life

10.9 Leakage detection/ vacuuming

A leak test must be carried out for the refrigerant circuit in accordance with the applicable guidelines of the installation.

The compressor must not exposed to dry air.

When vacuuming the entire refrigeration system, ensure that the compressor and the system are connected.

During the vacuuming, the oil heater is energized. Required a vacuum of at least 1.5 mbar (using a vacuum pump with a shut-off valve); repeat this operation several times if necessary.



**WARNING:**

Prohibit starting the compressor under vacuum condition.

The compressor has passed the relevant pressure tests, so the user does not need to do the relevant pressure tests. If the user needs to test by himself, please not exceed the design pressure value on the nameplate.

**WARNING:**

The test pressure must not be higher than the permissible operating pressure of the unit and its pressure vessel.

10.10 Lubricant charge

The operating procedures for filling oil are as follows:

- ✓ Vacuum the gas in the entire refrigeration circulation system, including the gas that is isolated in the compressor by the suction and discharge valves of the compressor;
- ✓ Connect the oil separator to the corresponding oil return inlet of the compressor;
- ✓ Control the amount of refrigerated oil in the range of the horizontal position shown in Figure 3;
- ✓ Close or tighten the freezing oil connection plug.

**WARNING:**

All compressors have been oil injected unless specifically requested. The nameplate of the compressor indicates the type of oil. Please consult with RefComp if other lubricants are acceptable (RefComp company will not be responsible for the warranty if the refrigerant authorized by RefComp company is not applied). If a separate delivery of lubricant is required, the lubricant must be charged into the compressor after the compressor has been vacuumed.

10.11 Refrigerant charge

Charge the liquid refrigerant into the condenser or directly into the refrigerant receiver. Complete the refrigerant charging during compressor operation. The discharge temperature must be at least 30K higher than the condensing temperature to avoid liquid backflow, and control the injection speed to avoid liquid hammer.

Insufficient refrigerant charge will result in low suction pressure or excessive degree of superheat. Please use the selection software RefComp to calculate the correct discharge temperature value for reference.



**WARNING:**

Charging liquid refrigerant through low pressure port of compressor is not permitted.

10.12 Start-up procedure

The compressor start-up procedures are as follow:

- ✓ Refer to the wiring diagrams for electrical connections;
- ✓ Perform the following preliminary inspections:
 - Check the oil level;
 - Check if the settings and functions of safety and protection equipment are normal;
 - Check if the high-pressure and low-pressure pressure protection switches are normal;
 - Check if the protection device of oil pressure (compulsory lubrication type compressor) is normal or equipped;
 - Confirm that there is no leakage in the system.
- ✓ The crankcase heater must be turned on 24 hours before the compressor is turned on, and the oil temperature must be at least 15 degrees above the ambient temperature;
- ✓ Ensure that there is a minimum refrigerant amount in the condenser;
- ✓ Open the suction and discharge shut-off valves and starts the compressor;
- ✓ Ensure the discharge temperature is at least 30K higher than the condensing temperature (Refer to RefComp selection software);
- ✓ Check that the pressure switch is working properly;
- ✓ Check the working parameters, such as evaporating pressure, condensing pressure, suction and discharge temperature etc. (Refer to RefComp selection software).

**WARNING:**

Before starting the compressor ensure that suction and discharge stop valves are fully open.

**WARNING:**

Compressor surface temperature may exceed 100°C or fall below 0°C during starting.

**WARNING:**

Liquid hammer and oil hammer must be avoided during compressor operation.



10.13 Trouble-shooting

Problem	Possible causes	Actions
The compressor doesn't start	<ul style="list-style-type: none"> a) Interface switch open b) Burned fuses c) Over- temperature relays open d) Faulty contactor e) Expansion valve doesn't open f) Failure electric motor g) Terminals loose h) Safety intervention i) The thermostat is set at High temperature 	<ul style="list-style-type: none"> a) Close the switch b) Check the electrical circuit and verify the absence of a short circuit or ground currents. Check for possible motor overload. Replace fuse after determining the cause of failure. See Item 12 c) Repair or replace d) Repair or replace e) Check continuity / insulation between terminals, check for burned insulation f) Check all electrical connections. Tighten the contacts g) Determine and eliminate causes of action securities, before restarting the motor h) If necessary, lower the thermostat temperature, remaining at 15K above the ambient temperature.
Excessive compressor noise	<ul style="list-style-type: none"> a) Brackets of pipes inadequate b) Inadequate clearance c) Liquid inside the compressor casing d) Rotor electric motor is not fixed e) Sound insulation / vibration inappropriate 	<ul style="list-style-type: none"> a) Replace, remove or add pipe fixing points b) Perform maintenance, replacing all the parts do not matching c) Control sizing and setting of expansion valve d) Control block key and bolt e) Check anchor condition,
Excessive Discharge pressure	<ul style="list-style-type: none"> a) Discharge valve partially closed b) Excess of refrigerant charge c) Failure capacitor d) Presence of non-condensable gases in refrigerant circuit e) Capacitor undersized or malfunctioning 	<ul style="list-style-type: none"> a) Open the valve b) Drain excess refrigerant c) Removing dirt in batteries or in the nozzles of the capacitor d) Eliminate non-condensable fluids e) Set condensing fluid flow or revise sizing
Insufficient Discharge pressure	<ul style="list-style-type: none"> a) Faulty condensing temperature regulation b) Intake valve partially closed c) Refrigerant amount not enough d) The compressor does not increase the load e) Condenser oversized f) Worn seal rings or Discharge valve 	<ul style="list-style-type: none"> a) Check operation of electronically control of condenser b) Open the valve c) Check for leaks. Charge refrigerant d) CR / SU Leads working. e) Review the design parameters f) Special maintenance compressor



Problem	Possible causes	Actions
Excessive suction pressure	<ul style="list-style-type: none"> a) Excessive eat load b) Excess of flow lamination c) The compressor does not increase the load d) Inadequate size of compressor e) Insufficient size of evaporator 	<ul style="list-style-type: none"> a) Decrease load or increase system potential b) Check valve bulb. Adjust superheat. Check expansion valve sizing. c) Check CR / SU d) Review the design parameters e) Review design parameters
Insufficient suction pressure	<ul style="list-style-type: none"> a) Lack of refrigerant b) Evaporator dirty or iced c) Clogged filter dryer in liquid line d) Suction line filter or compressor intake filter clogged e) Faulty expansion valve f) Condensing temperature too low g) Pump or evaporator fan not working 	<ul style="list-style-type: none"> a) Check for leaks. Charge refrigerant b) Clean or defrost c) Replace the cartridge d) Clean filter e) Check and reset valve to proper superheat. Repair or replace if necessary f) Check condensing temperature control devices g) Check and restart
The compressor doesn't work at part load	<ul style="list-style-type: none"> a) Faulty CR Lead b) Stem of CR Lead blocked 	<ul style="list-style-type: none"> a) Replace b) Replace
The compressor doesn't increase the load	<ul style="list-style-type: none"> a) Faulty CR Lead 	<ul style="list-style-type: none"> a) Replace
Increasing and decreasing capacity steps too short	<ul style="list-style-type: none"> a) Oversized expansion valve causes an excessive suction pressure 	<ul style="list-style-type: none"> a) Control the sizing of expansion valve
The oil pressure gauge gives a low pressure	<ul style="list-style-type: none"> a) No lubricant b) Too much condensation in the compressor casing c) Pressure drops along the pipes to the oil pressure probe d) Pipes to the oil probe clogged e) Gasket of oil pump installed incorrectly f) Oil pressure gauge defective g) Faulty delivery valve of pump h) Device for reverse rotation oil pump is stuck in the wrong place. i) Faulty oil pressure switch. j) Damaged oil pump k) Damaged pump shaft key l) Damaged bearings m) Faulty components of CR Lead 	<ul style="list-style-type: none"> a) See paragraph 3.7 b) Supply crankcase Heater. Set the expansion valve in order to achieve greater superheating. Check solenoid valve of liquid line c) Check and tighten attack of filter d) Clean e) Check the pump seal. All holes of the gasket must match the holes in service pump and pump support. f) Repair or replace. Keep valve closed except during gauge reading g) Repair or replace. h) Reverse two phase of power supply. i) Repair or replace. j) Replace k) Replace damaged parts l) Compressor Maintenance m) Replace damaged parts



Problem	Possible causes	Actions
Oil leakage of compressor	a) Oil trapped in the refrigeration pipes or in the evaporator b) Oil leaks from components of CR Lead c) Low speed in the suction pipes d) Excessive leakage from oil scraper rings in the pistons	a) Check speed of refrigerant b) Replace damaged components of CR Lead c) Check sizing of suction pipes d) Maintenance of the compressor
Over current relays open	a) Excessive condensing temperature b) Fuse open on one phase, resulting in single-phase operation c) Low voltage at full load d) Contacts of the power cables loose e) Faulty relay f) Overload Relays sized incorrectly g) High temperature of the overcurrent relay. h) Damaged power wires or on the ground i) Lack of phase resulting in imbalance of tension and in a single-phase operation j) Failure to complete insertion of the winding in the electric motor (if PW) or Δ winding k) Faulty or on the ground wirings l) Compressor seized	a) See remedies to discharge temperature. b) Find the cause of the opening relay, repair and replace fuse c) Check line voltage and verify which phase has excessive voltage drop d) Check and tighten all terminals e) Repair or replace f) Refer to nameplate data relay for proper sizing g) Ventilate the electrical box in which is located the relay. h) Repair or rewire i) Check voltage power line. Do not restart until the error was not corrected. j) Repair or replace the contactor or timer device k) Repair or rewind motor l) Special maintenance
Compressor starts and stops too close	a) Temperatures of differential thermostat too close b) Losses from the solenoid valve c) Too High refrigerant charge d) Lack of refrigerant e) Malfunction of the control valve of working fluids in condenser and evaporator.	a) Check the temperatures of the evaporator. Adjust the temperature differential, However, avoiding the formation of ice. b) Replace the solenoid valve c) Remove excess d) Check that there are no leaks. Repair and add refrigerant. e) Check the temperature setting of the control valve. Clean, repair or replace if necessary.

Tab. 8

11 MAINTENANCE

11.1 Information for maintenance

The steps for the electric motor, in addition to measures of isolation and current already mentioned, are:

- Control of the state and the temperature of electrical cables from the contactor to the motor terminal;
- Check the tightness of the electrical cables to terminals.



11.2 Lubricant-refrigerant system

If the working conditions of the system are correct and the lubricant-refrigerant system is free of contaminants, the lubrication circuit and the motor insulation will be maintained in good condition, the compressor will operate for long without problems.

Good working conditions of the system are determined by:

- a proper suction superheating;
- working temperature within the application range;
- proper charge of refrigerant;
- smooth operation of the compressor (without short cycles of work, proper oil return, starts not close). In practice, it must be avoided anything that may cause flooding or incorrect flow of refrigerant, or a lack of oil to the compressor.

The contaminants or undesirable components in the circuit, are for the most part:

- air,
- water,
- iron oxide (red or black Fe_2O_3 Fe_2O_4)
- copper oxides (red Cu_2O , CuO or black)
- solid particles, metal dust or dirt.

Substances whose presence is less frequent, but not less dangerous, are:

- antifreeze
- welding materials,
- chlorinated solvents,
- colours to verify losses,
- nitrogen or other gases that cannot switch to a liquid state.

The dangerous effects of contaminants are sludges, corrosion, coppering and icing with the following damage of compressor

11.3 Sludges

11.3.1 Main causes

The sludge are solid materials derived from the splitting of the molecule from oil. The process of formation of sludge begins with the High temperatures and the presence of air which cause acids. These acids cause a process of decomposition of the refrigerant which accelerates the formation of sludge. When acids are formed, they react with the metal elements of the components forming insoluble metal salts in both the refrigerant and oil. Mineral acids form salt crystals, which tend to adhere to the surfaces modifying them. Mineral acids are more corrosive in the presence of moisture.

11.3.2 Low to avoid sludge

The sludge is avoided by keeping the plant clean and dry, avoiding introducing air, using only the oil recommended by RefComp, which are High-quality oils.



11.4 Corrosion

11.4.1 Main causes

- Very High operating temperatures can cause corrosion also in a relatively clean plant. However, in the presence of contaminants, even moderately elevated temperatures can cause more severe corrosion than in the case of High temperatures and lack of contaminants. The air with high moisture causes the formation of rust. If in the system there are also acids, the red iron oxide (Fe_2O_3) forming, causes the generation of iron salts and of other water.
- The presence of welded materials can still lead to the formation of metal salts
- The methyl alcohol (used as antifreeze) may react with aluminium, causing corrosion
- The adoption of inappropriate methods of soldering leads to the introduction in the system of contaminants such pickling agent, welded materials or, under the influence of heat, the formation of oxides of copper and iron on the metal surfaces inside.

11.4.2 How to avoid corrosion

Keep the system in a satisfactory state of cleanliness, which means that it is necessary to prevent the introduction of any contaminant.

Use only refrigerants of qualified suppliers. The refrigerant must be supplied in original container, filled by the manufacturer and use only the lubricants recommended by RefComp. Avoid having discharge temperatures higher than those provided by the process. Contact RefComp in case of uncertainty or doubt.

11.5 Coppering

11.5.1 Main causes

The coppering is due to the high temperature and to contaminations such as water, air or other which dissolve the copper in the oil.

Subsequently, the dissolved copper precipitates in the oil on the very hot metal parts. The coppering happens often in the shafts and near the valves, where the temperature is very high.

11.5.2 How to avoid coppering

- Avoid High operation temperatures which can cause a partial decomposition of the oil and refrigerant and promote the formation of acids that corrode copper. The maximum recommended reachable temperature is 120 ° C. In some cases it can be tolerated occasional spikes in temperature 30°C higher. In all cases, the lower the service temperature, the better the results.
- Use only the recommended lubricants and also make sure that its viscosity corresponds to that request.
- Avoid contamination with welded, chlorinated solvents and other contaminants capable of causing, directly or indirectly, the formation of copper salts.
- In realizing the pipes, it's recommended to use clean copper pipes and to prevent the oxidation of the metal during welding or brazing.



11.6 Icing

11.6.1 Main causes

When the moisture in refrigerant exceeds the maximum allowable value, causes the formation of ice crystals that block the expansion valve or the suction filter avoiding the circulation of the refrigerant.

If the valve is blocked, it will cause a strong fluctuation of evaporating pressure due to the continuous forming and melting of ice.

If the suction filter is blocked, it will cause a High pressure difference in the filter that could blow the filter with the risk of burning the motor.

11.6.2 How to avoid icing

Avoid the presence of water in the system following exactly installation and charging rules. Use only refrigerants of qualified suppliers. The refrigerant must be supplied in original container, filled out by the manufacturer and use only those lubricants recommended by RefComp. Avoid using lubricants in containers already open. Install dehydrator filters in liquid line.

11.7 Relief for maintenance

It's suggested to create an operation register used to record the data of the compressor: date, time, step of capacity (anyway it is preferable to report the data at full), suction pressure, suction gas temperature, Discharge pressure, Discharge temperature, oil pressure, oil temperature, voltage, current (6 values, all the power cables of the motor), oil level, oil acidity, electrical insulation (with stand still compressor, of course).

Concerning the frequency and the kind of control, see the table below:

Action	Weekly frequency	Monthly frequency	Two-monthly frequency	Annual frequency
Reading and recording the level of refrigerant pressure	X			
Reading and recording the level of oil pressure and calculate the net oil pressure ⁽¹⁾	X			
Reading and recording voltage power line to the electric motor	X			
Reading and recording the current of the power line to the electric motor	X			
Check compressor oil level	X			
Check the refrigerant charge through the light oil	X			
Check for proper heating of the gas inlet (the inlet gas temperature control)		X		
Check the setting of all safety devices		X		
Check all contactors and all electrical contacts		X		
Check moisture indicator of the refrigerant		X		
Check operation of the solenoid valve		X		
Check condition of the oil in the compressor			X	
Check condition of the oil in the compressor			X	
Check the status of the capacitor (battery or heat exchanger)				X



Tab. 9

Comparing the data of operation, in particular the discharge temperature, it can be understood if the changes can detect hidden faults or future failures.

In addition to this data should be recorded the outside state, with regard to cleaning and colour, of some parts of the compressor and of the plant, for example if some parts are oily or dirty but are just not very greasy.

By the time it's possible to judge the changes, for example if some parts are heated, the colour could be changed.

11.8 Rules for a good oil management

- Buy lubricant in smaller containers and only in relation to the immediate needs.
- Make sure the type and viscosity of lubricant is suitable for the application.
- Do not transfer the oil from one container to another, if it comes into contact with air, the oil absorbs moisture. The air is the main contaminant.
- Normally supplied in sealed containers, should never be exposed to air for longer than is absolutely necessary to pour from the container into the crankcase of the compressor.
- It would have no smell. However, it is good practice to compare it with the smell of the new oil.
- If it has a pungent odour, almost unbearable, is not good. The colour is not a requirement to be judged in an absolute way, however it is good practice to compare it with the colour of the new oil. If it's blue, green, brown or black, is to change, after doing an oil change it is necessary to check carefully what will be the development of quality of new oil (control, viscosity, acidity, moisture content and extraneous). The tests to trust are those made in chemical laboratories qualified.
- Monitor the oil level in the early days of operation to make sure that the oil returns regularly and, if necessary, add oil to restore the proper level.

12 EXTENT OF DELIVERY

12.1 Standard delivery

- SPS21-1.5 ÷ SPS41-22 star-connection motor (400V / 3 / 50Hz) or delta-connection motor (230V / 3 / 50Hz);
- SPS42-29 ÷ SPS42-48 part-winding start motor (400V / 3 / 50Hz-460V / 3 / 60Hz);
- Crankcase heater;
- Discharge stop valve;
- Suction stop valve;
- Rubber vibration damper;
- Direct-on-line (DOL);
- Pressure relief valve;
- Oil sight glass;
- Oil charge: special POE68 for CO2 application
- PTC thermistor resistor;
- INT69 B2 protection module
- IP54 electrical box;
- Nitrogen protection;

12.2 Optional accessories

- Motor with special voltage;
- Photoelectric oil level switch assembled (only applicable to splash lubrication compressors);
- Special voltage for electronic parts (electronic protection module, crankcase heater).
- Lubricant: in case of booster system where is installed SPS and SPT in the same circuit, the lubricant charged on SPT must be charged also on SPS.

RefComp

SRM Italy S.r.l.

Via E. Majorana 10/12 – 36045 Lonigo (VI) - Italy; tel/fax.: +39 0444 726726
info@refcomp.it - www.refcomp.it

